

STANLEY®

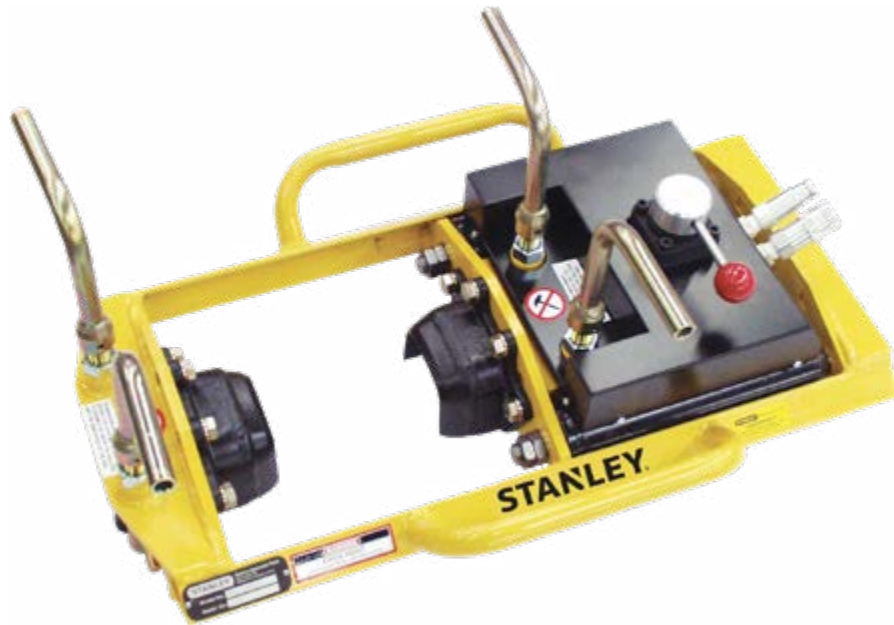

POWERFUL AND LIGHTWEIGHT

20,000 lbs (89,000 Nm) of force, yet weighs only 90 lbs (41 kg)



WELL BALANCED DESIGN

Ensures safe and easy handling



IMPROVED ROLLER SYSTEM

Tapered roller shaft for increased durability



EASY ALIGN BLADES

Enhanced alignment ensures precision and efficiency

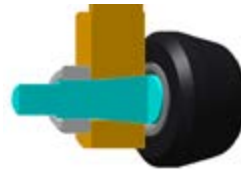

WS10 WELD SHEARS

STANLEY's Weld Shear combines power and lightweight design, making it the perfect tool for shearing thermite welds and head repairs with over 20,000 lbs (89,000 Nm) of force. The WS10321A features an efficient, well-balanced, and ergonomic design that allows for shearing before dismantling the weld mold, reducing setup time and boosting productivity. Its in-line pump handle ensures stability by preventing rocking on the rail during operation.

WS10 WELD SHEARS

FEATURES

- In-line handle improves control and reduces wrist strain
- Controls placed away from shear for operator safety
- The 4 easy-to-set-up hold downs are quarter-turn clamps that secure the weld shear to the rail, allowing for quick setup, adjustable tightness, and accommodation of different application needs for precise operation
- Redesigned roller shaft to enhance strength and durability
- Internal flow control maintains controlled shear speed to mitigate risk of hot tears

SPECIFICATIONS

CAPACITY	20000 LBS / 89000 NM
PRESSURE RANGE	2000 PSI / 140 BAR
FLOW RANGE	3 - 10 GPM / 11 - 38 LPM
WIDTH	19.5 IN. / 49.5 CM
WEIGHT	90 LBS / 41 KG
HEIGHT	12 IN. / 30.4 CM
MAXIMUM BACK PRESSURE	250 PSI / 17 BAR
HYDRAULIC PRESSURE	1000 - 2000 PSI / 70 - 140 BAR
HOSE WHIPS	NO
PORTING	-8 SAE O-RING
COUPLERS	HTMA FLUSH FACED COUPLER

ORDER INFORMATION

PART NO.	DESCRIPTION
WS10321A	LIGHTWEIGHT WELD SHEAR
WS10321AB	LIGHTWEIGHT WELD SHEAR WITH STUCCHI COUPLERS
WS1030101	WELD SHEAR (CE POWER UNIT)
WS1022001A	WELD SHEAR HAND PUMP "NO BLADES"
WS102200A	WELD SHEAR HAND PUMP B;LADE SET "A" (132 LB RAIL-27947)
WS10220AA	WELD SHEAR HAND PUMP BLADE SET "B" (115LB RAIL-27986)

ACCESSORIES

PART NO.	DESCRIPTION
27948	SHEAR BLADE SET FOR RAIL SIZES 122 LB - 142 LB
27989	SHEAR BLADE SET FOR RAIL SIZES 75 LB -119 LB / 54 KG - 60 KG
34370	SHEAR BLADE SET FOR RAIL SIZES 48 KG (RAILTECH)
35742	SHEAR BLADE SET FOR RAIL SIZES 50 KG AND SMALLER
67302	BLADE SET A (105 - 155 LB / YD (47 - 70 KG / M) RAIL*)
67303	Blade Set B (60 - 130 LB / yd (41 - 60 kg / M) Rail*)
67304	Blade Set C (60 - 90 LB / yd (36 - 60 kg / M) Rail*)

*DEPENDS ON RAIL TYPE

STANLEY®

3810 SE Naef Road // Milwaukie, OR 97267 // 833-723-1843 // www.IndustrialToolsAndAttachments.com

2025.04.29