



STANLEY[®]

Hydraulic Tools

UNDERWATER

**PRODUCT
CATALOG**

2014

TP08 TRASH PUMP DREDGE/DEWATERING

STANLEY®

The **TP08** is a heavy duty submersible and self priming hydraulic trash pump with 4" NPT discharge.



SPECIFICATIONS

Capacity	4" NPT with 4" Camlock
Performance	800 gpm / 3,028 lpm
Flow Range	7-10 gpm / 26-38 lpm
Working Pressure	2000 psi / 140 bar
Full Relief Setting	2250 psi / 155 bar
Weight	63 lbs / 28½ kg
Length	18" / 45.7 cm
Width	19" / 48.3 cm
Hydraulic Ports	10 SAE pressure 12 SAE return
Connection	½" NPT
Couplers	Yes
Hose Whips	No



With over 800 gpm of output flow, this pump is capable of pumping high volumes of water, sand slurries gravel, mud and solids up to 4" in diameter. The **TP08** is used for dewatering, dredging, cleaning and as a effective bilge pump. The gear motor is direct drive to the cast iron impeller with easy access for clean out of the fabricated steel volute. See chart below for gpm discharge at flow.

TP08 PERFORMANCE GRAPH

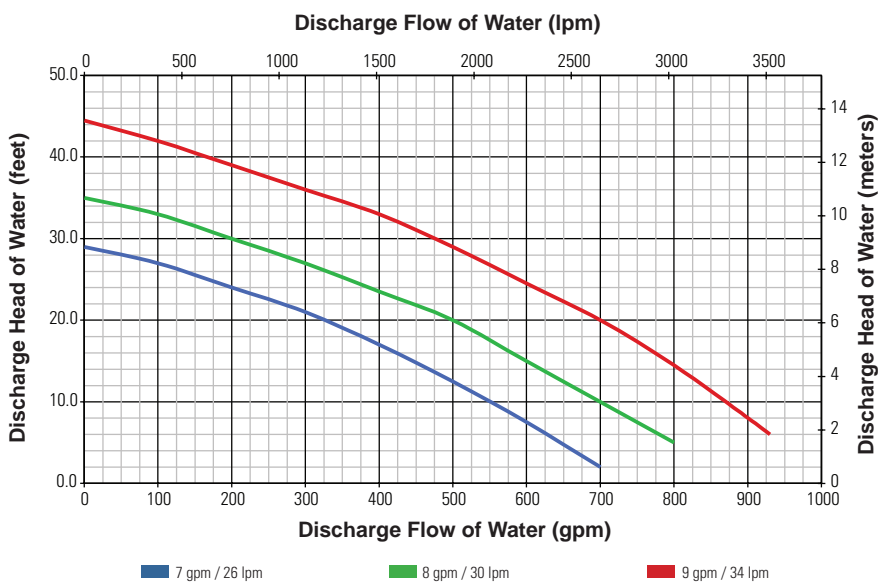

FEATURES

- Submersible and Self Priming
- Dredges solids up to 3" in size
- Removes sand, clay and mud from work structures
- 800 gpm (3,028 lpm) discharge
- Easy volute inspection and clean out
- Can run dry without damage
- 4" discharge
- Steel volute, cast iron impeller & polyethylene wear plates
- CE Certified

TP08 TRASH PUMP DREDGE/DEWATERING

STANLEY®

ORDERING INFORMATION

PART NUMBER

TP08013 Submersible Trash Pump, CE, 800 gpm output, 4" NPT/Camlock, with FF couplers

ACCESSORIES

- | | |
|--------------|--|
| 03974 | Flush-Face Coupling Set, ½" NPT |
| 31848 | Dual Hose, 50' x ½", with couplers |
| 31972 | Dual Hose, 25' x ½", with couplers |
| 58633 | Twinned Hose, 25' x ½", with couplers |
| 58634 | Twinned Hose, 50' x ½", with couplers |
| 65624 | Discharge Hose, lay-flat, 4" diameter x 25' with male & female 4" camlock couplers |

When hydraulic hose exceeds 100' (30.4 m) in length, increase I.D. of both pressure and return hose. For more information, consult Stanley Hydraulic Tools.

IMPORTANT

To fill out a Product Warranty Recording form and for information on your warranty visit stanleyhydraulic.com and select the Warranty tab.



Note: The warranty recording form must be submitted to validate the warranty.

All Stanley Hydraulic Tools, parts, accessories and allied equipment are subject to design improvements, specifications and price changes at any time without notice and with no obligation to units already sold. Weights, dimensions and operating specifications listed herein are subject to change without notice. Where specifications are critical to your applications, please consult Stanley Hydraulic Tools.

TP03 TRASH PUMP DREDGE/DEWATERING

STANLEY®

The **TP03** is a self priming hydraulic dewatering and trash pump with 3" NPFT discharge.



SPECIFICATIONS

Capacity	3" NPTF with 3" Camlock
Performance	450 gpm / 1688 lpm
Flow Range	7-9 gpm / 26-34 lpm
Working Pressure	2000 psi / 140 bar
Full Relief Setting	2250 psi / 155 bar
Weight	31 lbs / 14 kg
Length	14" / 35½ cm
Width	12" / 30.4 cm
Hydraulic Ports	-8 SAE O-ring
Connection	¾" Male Pipe Adapter
Couplers	Yes
Hose Whips	No



With 450 gpm of output flow, this pump is an efficient way to move large volumes of liquid with concentrations of solids up to 25% by volume. The **TP03** handles solids up to 3" in size and is used for dredging and light cleaning tasks. The urethane bowl and impeller is abrasion resistant, resilient and impervious to petrochemical solvents. See chart below for gpm discharge at flow.

TP03 PERFORMANCE GRAPH

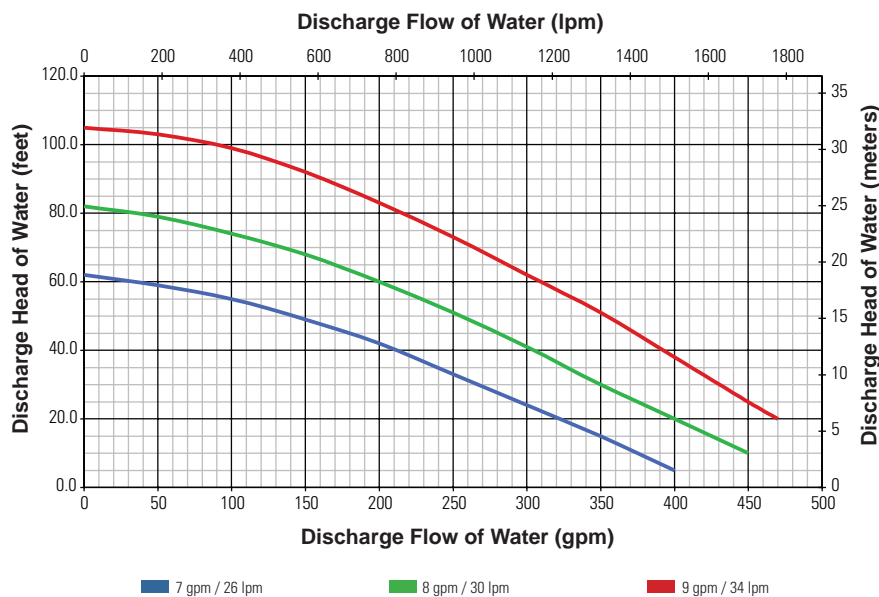

FEATURES

- Submersible and Self Priming
- Dredges solids up to 3" in size
- Removes sand, clay and mud from work structures
- 450 gpm (1688 lpm) discharge
- Easy bowl inspection and clean out
- Built in reverse flow check
- Can run dry without damage
- 3" discharge
- CE Certified

TP03 TRASH PUMP DREDGE/DEWATERING

STANLEY®

ORDERING INFORMATION

PART NUMBER

TP0300301 Submersible Trash Pump, CE, urethane bowl & impeller, 450 gpm output, 3" NPTF/Camlock, with FF couplers

ACCESSORIES

03971	Flush-Face Coupling Set, 3/8" NPT
03974	Flush-Face Coupling Set, 1/2" NPT
06830	Hose Whip 18" long, -8 SAE x 1/2" NPT
31848	Dual Hose, 50' x 1/2", with couplers
31972	Dual Hose, 25' x 1/2", with couplers
58633	Twinned Hose, 25' x 1/2", with couplers
58634	Twinned Hose, 50' x 1/2", with couplers
52720	Coupler, 3" NPT x 3" Camlock
56761	Discharge Hose, lay-flat, 3" diameter x 25' with male & female 3" camlock couplers
15248	Adapter, 3", female camlock x male fire hose (NH) thread

When hydraulic hose exceeds 100' (30.4 m) in length, increase I.D. of both pressure and return hose. For more information, consult Stanley Hydraulic Tools.

IMPORTANT

To fill out a Product Warranty Recording form and for information on your warranty visit stanleyhydraulic.com and select the Warranty tab.

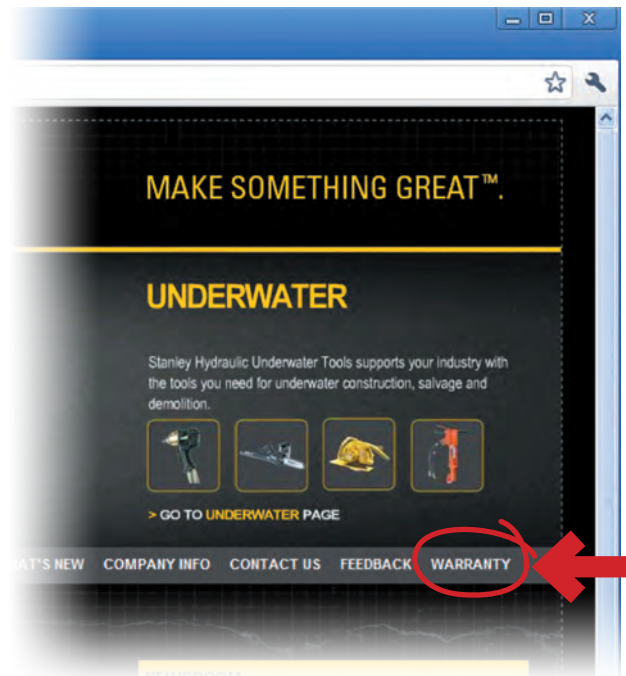

Note: The warranty recording form must be submitted to validate the warranty.

All Stanley Hydraulic Tools, parts, accessories and allied equipment are subject to design improvements, specifications and price changes at any time without notice and with no obligation to units already sold. Weights, dimensions and operating specifications listed herein are subject to change without notice. Where specifications are critical to your applications, please consult Stanley Hydraulic Tools.

SM50 SUBMERSIBLE PUMP DEWATERING/JETTING

STANLEY®



SPECIFICATIONS

Capacity	3" NPTF with 3" Camlock
Performance	500 gpm / 1890 lpm
Flow Range	7-12 gpm / 26-45 lpm
Working Pressure	1000-2000 psi / 70-140 bar
Full Relief Setting	2250 psi / 155 bar
Weight	22 lbs / 10 kg
Length	11½" / 29.2 cm
Width	12" / 30.5 cm
Hydraulic Ports	-8 SAE O-ring
Connection	¾" Male Pipe Adapter
Couplers	Yes
Hose Whips	No



The **SM50** Submersible Pump is a self priming hydraulic dewatering pump with 3" NPFT discharge. With 500 gpm (30,000 gph) of discharge flow, this pump is an excellent dewatering pump as well as a jetting pump. The cast stainless steel semi-closed impeller resist corrosion and the cast aluminum housing fits the need for high volume and high head pump applications. Can draw water down to 3½".

See chart below for gpm discharge at flow.

SM50 PERFORMANCE GRAPH

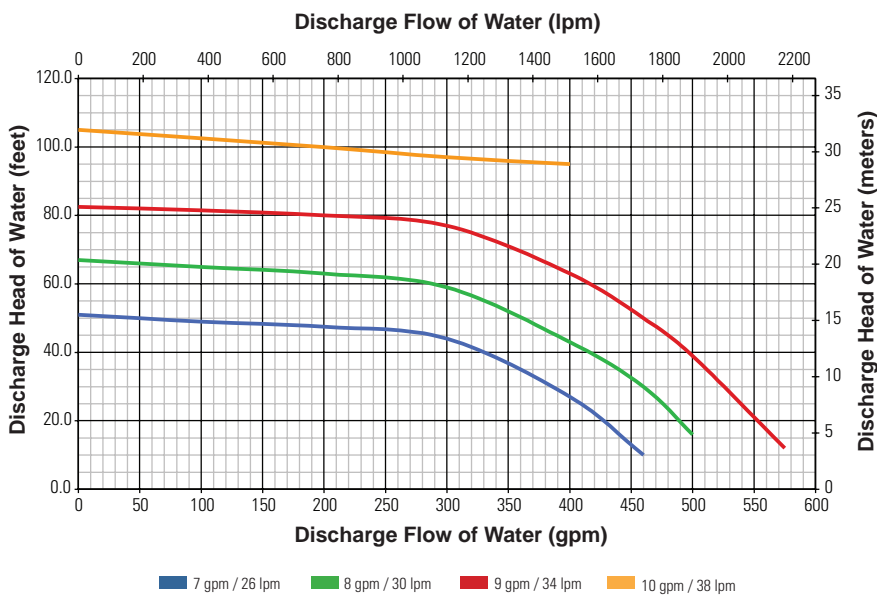

FEATURES

- Stanley Hyrevz gear motor direct drive to impeller
- Stainless Steel impeller and fasteners
- Submersible and Self Priming
- Can run dry without damage
- 500 gpm (1890 lpm)
- 3" discharge
- Cast-in lifting eye
- CE Certified



SM50 SUBMERSIBLE PUMP DEWATERING/JETTING

STANLEY®

ORDERING INFORMATION

PART NUMBER

SM50100 Submersible Pump, stainless steel impeller, 500 gpm output, 3" NPTF/Camlock, with FF couplers

ACCESSORIES

03971 Flush-Face Coupling Set, 3/8" NPT

03974 Flush-Face Coupling Set, 1/2" NPT

06830 Hose Whip 18" long, -8 SAE x 1/2" NPT

31848 Dual Hose, 50' x 1/2", with couplers

31972 Dual Hose, 25' x 1/2", with couplers

58633 Twinned Hose, 25' x 1/2", with couplers

58634 Twinned Hose, 50' x 1/2", with couplers

52720 Coupler, 3" NPT x 3" Camlock

56761 Discharge Hose, lay-flat, 3" diameter x 25' with male & female 3" camlock couplers

15248 Adapter, 3", female camlock x male fire hose (NH) thread

When hydraulic hose exceeds 100' (30.4 m) in length, increase I.D. of both pressure and return hose. For more information, consult Stanley Hydraulic Tools.

IMPORTANT

To fill out a Product Warranty Recording form and for information on your warranty visit stanleyhydraulic.com and select the Warranty tab.



Note: The warranty recording form must be submitted to validate the warranty.

All Stanley Hydraulic Tools, parts, accessories and allied equipment are subject to design improvements, specifications and price changes at any time without notice and with no obligation to units already sold. Weights, dimensions and operating specifications listed herein are subject to change without notice. Where specifications are critical to your applications, please consult Stanley Hydraulic Tools.

SM21 SUBMERSIBLE PUMP

STANLEY®



The **SM21** Submersible Pump is a small diameter (caisson style) self priming hydraulic dewatering pump with a discharge flow of 300 gpm thru a 2½" NPFT discharge. At only 6¼" wide the **SM21** can fit in small openings. The cast iron impeller is within ¾" of the base allowing it to remove more liquids than other pumps. See chart below for gpm discharge at flow.



SPECIFICATIONS

Capacity	2½" NPFT Discharge
Performance	300 gpm / 1135 lpm
Flow Range	4-9 gpm / 15-34 lpm
Working Pressure	1000-2000 psi / 70-140 bar
Full Relief Setting	2250 psi / 155 bar
Weight	22½ lbs / 10 kg
Length	16½" / 42 cm
Width	6¼" / 15.9 cm
Hydraulic Ports	- 6 SAE O-ring
Connection	¾" Male Pipe Adapter
Couplers	Yes
Hose Whips	Yes

FEATURES

- Stanley Hyrevz gear motor
- Stainless Steel fasteners
- Submersible and Self Priming
- Can run dry without damage
- 300 gpm (1135 lpm)
- 2½" discharge
- Cast-in lifting eye
- CE Certified

SM21 PERFORMANCE GRAPH

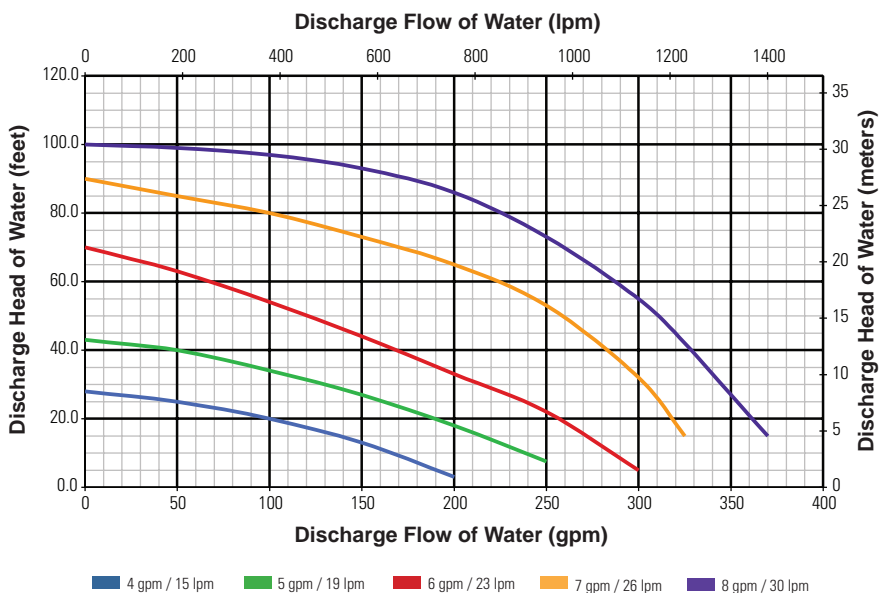

SM21 SUBMERSIBLE PUMP

STANLEY®

ORDERING INFORMATION

PART NUMBER

SM2151101 Submersible Pump, CE, 8 gpm, cast iron impeller, 300 gpm, output, 2½" NPTF, with FF couplers

ACCESSORIES

03971	Flush-Face Coupling Set, ¾" NPT
03974	Flush-Face Coupling Set, ½" NPT
31848	Dual Hose, 50' x ½", with couplers
31972	Dual Hose, 25' x ½", with couplers
58633	Twinned Hose, 25' x ½", with couplers
58634	Twinned Hose, 50' x ½", with couplers
02183	Fire Hose, 25' x 2½" Diameter
02317	Fire Nozzle, 1" Output
05133	2½" Threaded Adapter, Pump to Fire Hose
05134	Fire Hose, 50' x 2½" Diameter
05135	Spanner Wrench for Pin Lug Coupler

When hydraulic hose exceeds 100' (30.4 m) in length, increase I.D. of both pressure and return hose. For more information, consult Stanley Hydraulic Tools.

IMPORTANT

To fill out a Product Warranty Recording form and for information on your warranty visit stanleyhydraulic.com and select the Warranty tab.

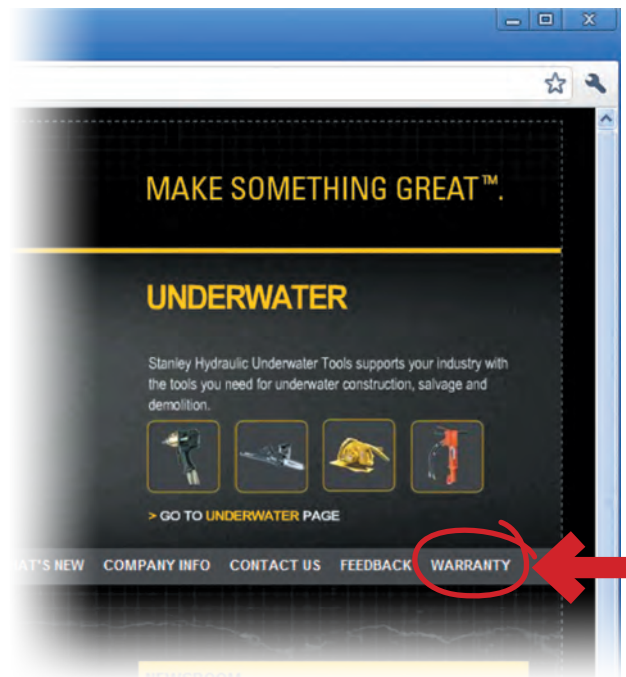

Note: The warranty recording form must be submitted to validate the warranty.

All Stanley Hydraulic Tools, parts, accessories and allied equipment are subject to design improvements, specifications and price changes at any time without notice and with no obligation to units already sold. Weights, dimensions and operating specifications listed herein are subject to change without notice. Where specifications are critical to your applications, please consult Stanley Hydraulic Tools.

SM20 SUBMERSIBLE PUMP

STANLEY®



SPECIFICATIONS

Capacity	2½" NPTF Discharge
Performance	250 gpm / 946 lpm
Flow Range	4-9 gpm / 15-34 lpm
Working Pressure	1000-2000 psi / 70-140 bar
Full Relief Setting	2250 psi / 155 bar
Weight	13.7 lbs / 6.3 kg
Length	7½" / 19 cm
Width	9.6" / 24 cm
Hydraulic Ports	-8 SAE O-ring
Connection	¾" Male Pipe Adapter
Couplers	Yes
Hose Whips	No



The **SM20** Submersible Pump is a light weight, self priming hydraulic dewatering pump with 2½" NPFT discharge. With a capacity of 250 gpm, this pump is good for quick dewatering jobs. The **SM20** is the smallest pump in our line up of five different models. See chart below for **SM20** gpm capacity.

FEATURES

- Stanley Hyrevz gear motor
- Stainless Steel fasteners
- Submersible and Self Priming
- Can run dry without damage
- Urethane or steel impeller
- 250 gpm (946 lpm)
- 2½" discharge
- CE Certified

SM20 PERFORMANCE GRAPH (SM20531, *SM20521)

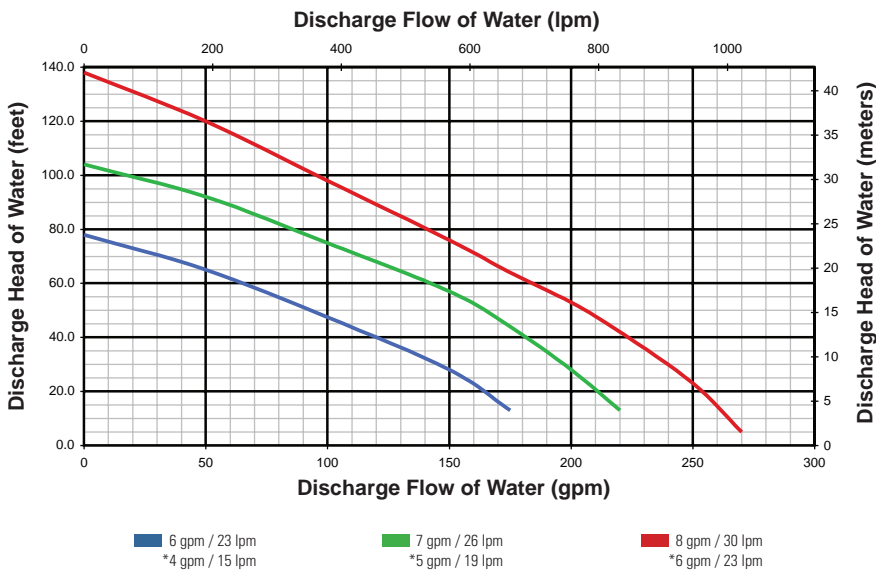

SM20 SUBMERSIBLE PUMP

STANLEY

ORDERING INFORMATION

PART NUMBER

SM2043101	Submersible Pump, 8 gpm, steel impeller, 250 gpm, output, 2½" NPTF, with FF couplers
SM2052101	Submersible Pump, CE, 5 gpm, urethane impeller, 250 gpm, output, 2½" NPTF, with FF couplers
SM2053101	Submersible Pump, CE, 8 gpm, urethane, impeller, 250 gpm, output, 2½" NPTF, with FF couplers

ACCESSORIES

03971	Flush-Face Coupling Set, ¾" NPT
03974	Flush-Face Coupling Set, ½" NPT
06830	Hose Whip 18" long, -8 SAE x ½" NPT
31848	Dual Hose, 50' x ½", with couplers
31972	Dual Hose, 25' x ½", with couplers
58633	Twinned Hose, 25' x ½", with couplers
58634	Twinned Hose, 50' x ½", with couplers
02183	Fire Hose, 25' x 2½" Diameter
02317	Fire Nozzle, 1" Output
05133	2½" Threaded Adapter, Pump to Fire Hose
05134	Fire Hose, 50' x 2½" Diameter
05135	Spanner Wrench for Pin Lug Coupler

When hydraulic hose exceeds 100' (30.4 m) in length, increase I.D. of both pressure and return hose. For more information, consult Stanley Hydraulic Tools.

IMPORTANT

To fill out a Product Warranty Recording form and for information on your warranty visit stanleyhydraulic.com and select the Warranty tab.



Note: The warranty recording form must be submitted to validate the warranty.

All Stanley Hydraulic Tools, parts, accessories and allied equipment are subject to design improvements, specifications and price changes at any time without notice and with no obligation to units already sold. Weights, dimensions and operating specifications listed herein are subject to change without notice. Where specifications are critical to your applications, please consult Stanley Hydraulic Tools.

SK58 UNDERWATER SINKER DRILL

STANLEY®



SPECIFICATIONS

Drill Capacity	3" (7.6 cm) Diameter hole, up to 20' (6 m) deep
Steel Type	1 in x 4¼" Hex Shank
Circuit Type	Open Center
Flow Range	7-9 gpm / 26-34 lpm
Optimum Flow	8 gpm / 30 lpm
Working Pressure	1500-2000 psi / 105-140 bar
Full Relief Setting	2250 psi / 155 bar
Rotation Speed	0-300 rpm
Weight (less tool bit)	70 lbs / 31.7 kg
Length	26" / 66 cm
Width (at handles)	18" / 46 cm
Hydraulic Ports	-8 SAE O-ring
Couplers	No (See Accessories)
Hose Whips	Yes (¾" NPT Male thread)
Air Port	½" NPT

FEATURES

- T-Handle with feathering on/off valve allows easy start and control
- Rotation speed adjustable between 0 and 300 rpm
- Stainless Steel spools and fasteners
- Four tie rod design for durability
- Uses standard rock drill steels: 1" x 4¼" Hex Shank
- Drills up to 3 in diameter hole up to 20' deep
- Operates in any position
- Requires air to clear holes of debris
- Trouble free drill steel latch retainer



The Stanley **SK58** Sinker Drill is a heavy duty rock drill designed for drilling underwater in concrete, rock and masonry. The feathering on/off valve makes starting the drill bit relatively easy. The **SK58** uses industry standard drill steel and can drill up to a 3" (75 mm) diameter hole up to 20' (6 m) deep. The direct drive rotation motor drives the 1" x 4¼" hex shank drill steel and is adjustable between 0 and 300 rpm. Air is required to clear holes of debris. Painted hi-visibility yellow.

SK58 UNDERWATER SINKER DRILL

STANLEY

ORDERING INFORMATION

PART NUMBER

SK58310 Sinker Drill, Underwater, Air Flush, 1 x 4¼", less couplers

ACCESSORIES

03971	Flush-Face Coupling Set, ¾" NPT
03974	Flush-Face Coupling Set, ½" NPT
31848	Dual Hose, 50' x ½", with couplers
31972	Dual Hose, 25' x ½", with couplers
58633	Twinned Hose, 25' x ½", with couplers
58634	Twinned Hose, 50' x ½", with couplers
05177	Carbide Rock Bit, for use with Air, 1¾" Diameter, H-Thread - Requires Drill Steel
05178	Carbide Rock Bit, for use with Air, 1½" Diameter, H-Thread - Requires Drill Steel
04914	Carbide Rock Bit, for use with Air, 2" Diameter, H-Thread - Requires Drill Steel
05170	Drill Steel for use with Air, 1 x 4¼", H-Thread, 24" U/C
05171	Drill Steel for use with Air, 1 x 4¼", H-Thread, 48" U/C

When hydraulic hose exceeds 100' (30.4 m) in length, increase I.D. of both pressure and return hose. For more information, consult Stanley Hydraulic Tools.

IMPORTANT

To fill out a Product Warranty Recording form and for information on your warranty visit stanleyhydraulic.com and select the Warranty tab.

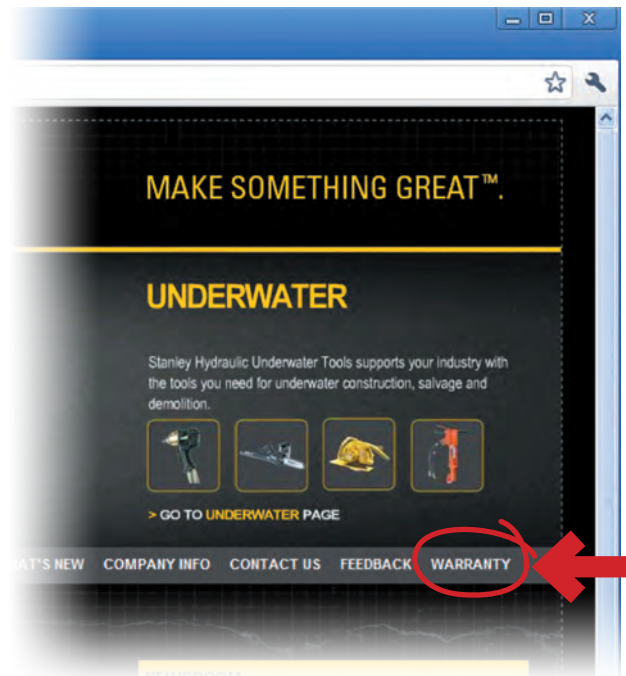

Note: The warranty recording form must be submitted to validate the warranty.

All Stanley Hydraulic Tools, parts, accessories and allied equipment are subject to design improvements, specifications and price changes at any time without notice and with no obligation to units already sold. Weights, dimensions and operating specifications listed herein are subject to change without notice. Where specifications are critical to your applications, please consult Stanley Hydraulic Tools.

IW24 UNDERWATER IMPACT WRENCH

STANLEY®



SPECIFICATIONS

Capacity	1½" Square Drive
Torque	800 -3500 ft lbs / 1088-4760 Nm
Flow Range	7-12 gpm / 26-45 lpm
Working Pressure	1800-2000 psi / 124-140 bar
Full Relief Setting	2250 psi / 155 bar
Weight	43 lbs / 19½ kg
Length	16½" / 41 cm
Width	5.1" / 13 cm
Hydraulic Ports	-8 SAE O-ring
Connect Size and Type	¾" Male Pipe Adapter
Couplers	No (See Accessories)
Hose Whips	No (See Accessories)

FEATURES

- Integral Stanley Hyrevz gear motor produces high torque
- Stainless Steel spools and fasteners
- Forward-Reverse with variable speed
- "D" style grip handle with inside trigger
- Feathering on/off trigger for precise control
- Adjustable impact intensity
- 3500 ft lbs/4760 Nm of maximum impact torque
- Durable swing hammer mechanism
- Cast-in lifting eye



The Stanley **IW24** is an extreme duty 1½" square drive impact wrench designed for the toughest underwater bolting applications. Powered by a Stanley integral Hyrevz motor, the **IW24** has a durable swing hammer impact mechanism with adjustable impact intensity from 800 to 3500 ft lbs (1088 to 4760 Nm) of torque. Designed to run from a wide range of hydraulic circuits, this wrench allows underwater bolting with the best in the most extreme applications. "D" style grip handle with side assist handle and hi-visibility yellow paint is standard.

IW24 UNDERWATER IMPACT WRENCH

STANLEY®

ORDERING INFORMATION

PART NUMBER

IW24360 Impact Wrench, Underwater, 1½" Square Drive, less couplers

ACCESSORIES

- | | |
|--------------|---------------------------------------|
| 03971 | Flush-Face Coupling Set, ¾" NPT |
| 03974 | Flush-Face Coupling Set, ½" NPT |
| 06830 | Hose Whip 18" long, -8 SAE x 1/2" NPT |
| 31848 | Dual Hose, 50' x ½", with couplers |
| 31972 | Dual Hose, 25' x ½", with couplers |
| 58633 | Twinned Hose, 25' x ½", with couplers |
| 58634 | Twinned Hose, 50' x ½", with couplers |

When hydraulic hose exceeds 100' (30.4 m) in length, increase I.D. of both pressure and return hose. For more information, consult Stanley Hydraulic Tools.

IMPORTANT

To fill out a Product Warranty Recording form and for information on your warranty visit stanleyhydraulic.com and select the Warranty tab.



Note: The warranty recording form must be submitted to validate the warranty.

All Stanley Hydraulic Tools, parts, accessories and allied equipment are subject to design improvements, specifications and price changes at any time without notice and with no obligation to units already sold. Weights, dimensions and operating specifications listed herein are subject to change without notice. Where specifications are critical to your applications, please consult Stanley Hydraulic Tools.

IW16 UNDERWATER IMPACT WRENCH

STANLEY®



SPECIFICATIONS

Capacity	1" Square Drive
Torque	500 -2500 ft lbs / 680-3400 Nm
Flow Range	7-12 gpm / 26-45 lpm
Working Pressure	1500-2000 psi / 105-140 bar
Full Relief Setting	2250 psi / 155 bar
Weight	26 lbs / 12 kg
Length	15" / 38 cm
Width	4.5" / 11 cm
Hydraulic Ports	-8 SAE O-ring
Connect Size and Type	3/8" Male Pipe Adapter
Couplers	(See Ordering Information)
Hose Whips	No (See Accessories)



The Stanley **IW16** is a heavy duty 1" square drive impact wrench designed for the toughest underwater bolting applications. Powered by a Stanley integral Hyrevz motor, the **IW16** has a durable swing hammer impact mechanism with adjustable impact intensity from 500 to 2500 ft lbs (680 to 3400 Nm) of torque. Designed to run from a wide range of hydraulic circuits. "D" style grip handle with multi-position assist handle and hi-visibility yellow paint is standard.

FEATURES

- Integral Stanley Hyrevz gear motor produces high torque
- Stainless Steel spools and fasteners
- Forward-Reverse with variable speed
- "D" style grip handle with inside trigger
- Feathering on/off trigger for precise control
- Adjustable impact intensity
- 2500 ft lbs/3400 Nm of maximum impact torque
- Durable swing hammer mechanism
- Cast-in lifting eye

IW16 UNDERWATER IMPACT WRENCH

STANLEY

ORDERING INFORMATION

PART NUMBER

IW16350 Impact Wrench, Underwater, 1" Square Drive, with couplers, CE

ACCESSORIES

03971	Flush-Face Coupling Set, 3/8" NPT
03974	Flush-Face Coupling Set, 1/2" NPT
06830	Hose Whip 18" long, -8 SAE x 1/2" NPT
31848	Dual Hose, 50' x 1/2", with couplers
31972	Dual Hose, 25' x 1/2", with couplers
58633	Twinned Hose, 25' x 1/2", with couplers
58634	Twinned Hose, 50' x 1/2", with couplers
31203	Extension, 10", 1" Drive
33276	Socket Retainer Pin, 1" Square Drive Socket
33277	Socket Retainer Ring, 1" Square Drive Socket

When hydraulic hose exceeds 100' (30.4 m) in length, increase I.D. of both pressure and return hose. For more information, consult Stanley Hydraulic Tools.

IMPORTANT

To fill out a Product Warranty Recording form and for information on your warranty visit stanleyhydraulic.com and select the Warranty tab.



Note: The warranty recording form must be submitted to validate the warranty.

All Stanley Hydraulic Tools, parts, accessories and allied equipment are subject to design improvements, specifications and price changes at any time without notice and with no obligation to units already sold. Weights, dimensions and operating specifications listed herein are subject to change without notice. Where specifications are critical to your applications, please consult Stanley Hydraulic Tools.

STANLEY

Stanley Hydraulic Tools | 3810 SE Naef Road | Milwaukie, Oregon 97267 | +01.503.659.5660 | 800.972.2647 | www.stanleyhydraulic.com

IW12 UNDERWATER IMPACT WRENCH

STANLEY®



SPECIFICATIONS

Capacity	¾" / 19 mm Square Drive
Torque	250 -1200 ft lbs / 340-1632 Nm
Flow Range	4-12 gpm / 15-45 lpm
Working Pressure	1000-2000 psi / 70-140 bar
Full Relief Setting	2250 psi / 155 bar
Weight	14 lbs / 6.4 kg
Length	11¼" / 28.6 cm
Width	4" / 10.2 cm
Hydraulic Ports	-8 SAE O-ring
Connect Size and Type	¾" Male Pipe Adapter
Couplers	(See Ordering Information)
Hose Whips	No (See Accessories)

FEATURES

- Integral Stanley Hyrevz gear motor produces high torque
- Stainless Steel spools and fasteners
- Forward-Reverse with variable speed
- Pistol grip style handle
- Adjustable impact intensity
- 1200 ft lbs/1632 Nm of maximum impact torque
- Oversized trigger with guard for operator comfort
- Plastisol handle for comfortable ergonomic grip
- Durable swing hammer mechanism
- Cast-in lifting eye



The Stanley **IW12** is a medium duty ¾" square drive impact wrench designed for underwater bolting and drilling applications. Powered by a Stanley integral Hyrevz motor, the **IW12** has a durable swing hammer impact mechanism with adjustable impact intensity from 250 to 1200 ft lbs (340 to 1632 Nm) of torque. Designed to run from a wide range of hydraulic circuits, this wrench allows underwater bolting in the most extreme applications. Trigger guard and hi-visibility yellow paint is standard.

IW12 UNDERWATER IMPACT WRENCH

STANLEY[®]

ORDERING INFORMATION

PART NUMBER

IW12340C Impact Wrench, Underwater, 3/4" Square Drive, less couplers

IW1234001 Impact Wrench, Underwater, CE, 3/4" Square Drive, with couplers

ACCESSORIES

03971 Flush-Face Coupling Set, 3/8" NPT

03974 Flush-Face Coupling Set, 1/2" NPT

06830 Hose Whip 18" long, -8 SAE x 1/2" NPT

31848 Dual Hose, 50' x 1/2", with couplers

31972 Dual Hose, 25' x 1/2", with couplers

58633 Twinned Hose, 25' x 1/2", with couplers

58634 Twinned Hose, 50' x 1/2", with couplers

01857 Adjustable Chuck & Adapter 3/4" sq female x 3/4" Chuck

When hydraulic hose exceeds 100' (30.4 m) in length, increase I.D. of both pressure and return hose. For more information, consult Stanley Hydraulic Tools.

IMPORTANT

To fill out a Product Warranty Recording form and for information on your warranty visit stanleyhydraulic.com and select the Warranty tab.



Note: The warranty recording form must be submitted to validate the warranty.

All Stanley Hydraulic Tools, parts, accessories and allied equipment are subject to design improvements, specifications and price changes at any time without notice and with no obligation to units already sold. Weights, dimensions and operating specifications listed herein are subject to change without notice. Where specifications are critical to your applications, please consult Stanley Hydraulic Tools.

ID07 UNDERWATER IMPACT DRILL

STANLEY®



SPECIFICATIONS

Capacity	½" / 12.7 mm Square Drive
Performance	Torque 500 ft lbs / 675 Nm
Flow Range	4-12 gpm / 15-45 lpm
Working Pressure	750-2000 psi / 50-140 bar
Full Relief Setting	2250 psi / 155 bar
Weight	7.2 lbs / 3.3 kg
Length	10" / 25.4 cm
Width	4¼" / 10.8 cm
Hydraulic Ports	-8 SAE O-ring
Connect Size and Type	¾" Male Pipe Adapter
Couplers	(See Ordering Information)
Hose Whips	(See Ordering Information)

FEATURES

- Integral Stanley Hyrevz gear motor produces high torque
- Stainless Steel spools and fasteners
- Forward-Reverse with variable speed
- 500 ft lbs/675 Nm of impact torque
- Oversized trigger with guard for operator comfort
- Wiper seals on reversing and trigger spool
- Built in reverse check valve ensures long seal life
- Plastisol handle for comfortable ergonomic grip
- Forward position of handle provides better balance
- Open Center/Closed Center-Dual Spool Feature
- Cast-in lifting eye



The Stanley **ID07** Impact/Drill is two hydraulic underwater tools in one - an impact wrench and a wood drill. The ½" square drive impact wrench delivers torque up to 500 ft lbs and can tighten and loosen nuts and bolts and drive lag screws. Use the **ID07** with the 05079 Adapter and wood boring bits for drilling in timbers up to 1½" diameter holes with no reactive torque to the diver. Trigger guard and hi-visibility yellow paint is standard.

ID07 UNDERWATER IMPACT DRILL

STANLEY

ORDERING INFORMATION

PART NUMBER

ID07920 Impact/Drill, Underwater, 1/2" Square Drive, less couplers

ID0792001 Impact/Drill, Underwater, CE, 1/2" Square Drive, w/hose whips and couplers

ACCESSORIES

03971 Flush-Face Coupling Set, 3/8" NPT

03974 Flush-Face Coupling Set, 1/2" NPT

31848 Dual Hose, 50' x 1/2", with couplers

31972 Dual Hose, 25' x 1/2", with couplers

58633 Twinned Hose, 25' x 1/2", with couplers

58634 Twinned Hose, 50' x 1/2", with couplers

When hydraulic hose exceeds 100' (30.4 m) in length, increase I.D. of both pressure and return hose. For more information, consult Stanley Hydraulic Tools.

Wood Boring Bits have 7/16" Quick Change, Hex Shank Requires Part # 05079 Adaptor for use with ID07 U/W Impact/Drill

05079 Adaptor 1/2" female sq. dr. x 7/16" QC Hex

27850 Wood Bit: 9/16" dia. x 8" x 12" OAL

27851 Wood Bit: 1 1/16" dia. x 8" x 12" OAL

27852 Wood Bit: 1 3/16" dia. x 8" x 12" OAL

27853 Wood Bit: 1 5/16" dia. x 8" x 12" OAL

27854 Wood Bit: 1 7/16" dia. x 8" x 12" OAL

27855 Wood Bit: 9/16" dia. x 12" x 16" OAL

27856 Wood Bit: 1 1/16" dia. x 12" x 16" OAL

27857 Wood Bit: 1 3/16" dia. x 12" x 16" OAL

27858 Wood Bit: 1 5/16" dia. x 12" x 16" OAL

27859 Wood Bit: 1 7/16" dia. x 12" x 16" OAL

27860 Wood Bit: 9/16" dia. x 18" x 22" OAL

27861 Wood Bit: 1 1/16" dia. x 18" x 22" OAL

27862 Wood Bit: 1 3/16" dia. x 18" x 22" OAL

27863 Wood Bit: 1 5/16" dia. x 18" x 22" OAL

27864 Wood Bit: 1 7/16" dia. x 18" x 22" OAL

IMPORTANT

To fill out a Product Warranty Recording form and for information on your warranty visit stanleyhydraulic.com and select the Warranty tab.

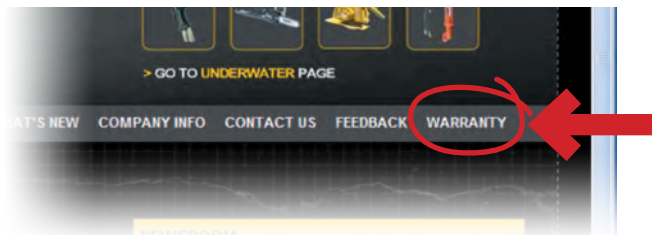

Note: The warranty recording form must be submitted to validate the warranty.

All Stanley Hydraulic Tools, parts, accessories and allied equipment are subject to design improvements, specifications and price changes at any time without notice and with no obligation to units already sold. Weights, dimensions and operating specifications listed herein are subject to change without notice. Where specifications are critical to your applications, please consult Stanley Hydraulic Tools.

HD45 UNDERWATER HAMMER DRILL

STANLEY®



The Stanley Hydraulic HD45 Hammer Drill is a heavy duty underwater model designed for drilling in concrete, rock and masonry.



The feathering on/off valve and adjustable rotation speed allows easy drill bit start-up and precise control. The high torque rotation motor drives standard 736 Skil hex carbide tipped drill bits and is capable of drilling a 2" diameter hole up to 29" deep. Fluted drill bits require no water or air to clear holes. Ideal for drilling holes for setting anchor bolts. Painted hi-visibility yellow.

SPECIFICATIONS

Chuck Capacity	Up to 2" diameter or 4" core bit
Steel Capacity	736 Skil hex
Circuit Type	Open Center
Flow Range	7-9 gpm / 26-34 lpm
Optimum Flow	8 gpm / 30 lpm
Working Pressure	1500-2000 psi / 105-140 bar
Full Relief Setting	2250 psi / 155 bar
Rotation Speed	0 - 300 rpm
Weight (less tool bit)	49 lbs / 22.2 kg
Length	24½" / 62.2 cm
Width (at handles)	14" / 35 cm
Hydraulic Ports	-8 SAE O-ring
Couplers	Varies with model (See ordering information)
Hose Whips	Yes (¾" NPT Male thread)

FEATURES

- T-Handle with large on/off trigger for precise control
- Stainless Steel spools and fasteners
- Forward-Reverse with adjustable bit rotation speed
- Feathering on/off valve allows easy start and control
- Uses 736 Skil fluted carbide tipped drill bits - requires no water/air to clear holes
- Drills ¾" to 2" diameter holes up to 29" deep and core drills up to 4" in diameter
- Operates in any position
- Trouble free drill steel latch retainer

HD45 UNDERWATER HAMMER DRILL

STANLEY

ORDERING INFORMATION

PART NUMBER

HD45310	Hammer Drill, Underwater, less couplers
HD4531001	Hammer Drill, Underwater, CE, Trigger Lock, with couplers

ACCESSORIES

03971	Flush-Face Coupling Set, 3/8" NPT
03974	Flush-Face Coupling Set, 1/2" NPT
31848	Dual Hose, 50' x 1/2", with couplers
31972	Dual Hose, 25' x 1/2", with couplers
58633	Twinned Hose, 25' x 1/2", with couplers
58634	Twinned Hose, 50' x 1/2", with couplers
02280	Carbide Bit, 3/4" x 24" OAL
05163	Carbide Bit, 7/8" x 24" OAL
02281	Carbide Bit, 1" x 24" OAL
02282	Carbide Bit, 1 1/4" x 24" OAL
05167	Carbide Bit, 1 1/2" x 24" OAL
02283	Carbide Bit, 2" x 24" OAL
04668	Carbide Bit, 1" x 18" OAL
04896	Carbide Bit, 1 1/4" x 36" OAL
27902	Percussion Core Bit, 2 1/2" diameter x 6" OAL (part #30279 required)
27904	Percussion Core Bit, 3" diameter x 6" OAL (Part #30279 required)
30279	HD45 (Skil 736) Adapter

When hydraulic hose exceeds 100' (30.4 m) in length, increase I.D. of both pressure and return hose. For more information, consult Stanley Hydraulic Tools.

IMPORTANT

To fill out a Product Warranty Recording form and for information on your warranty visit stanleyhydraulic.com and select the Warranty tab.

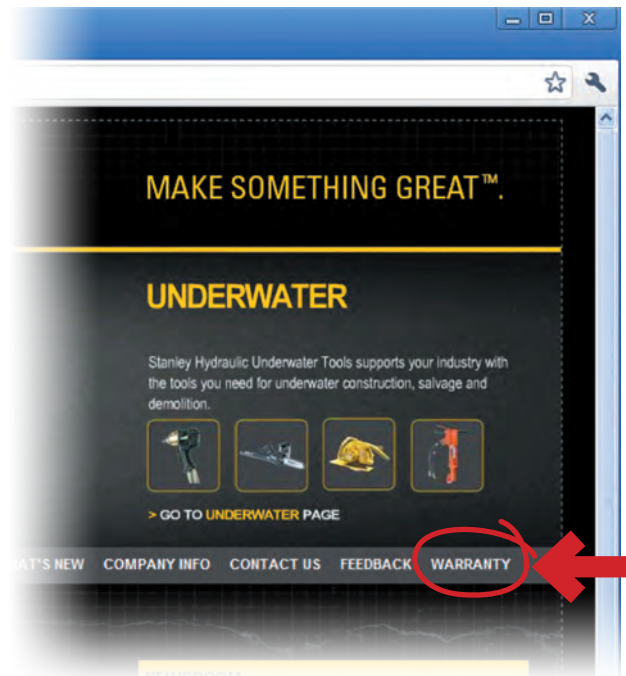

Note: The warranty recording form must be submitted to validate the warranty.

All Stanley Hydraulic Tools, parts, accessories and allied equipment are subject to design improvements, specifications and price changes at any time without notice and with no obligation to units already sold. Weights, dimensions and operating specifications listed herein are subject to change without notice. Where specifications are critical to your applications, please consult Stanley Hydraulic Tools.

GT SERIES POWER UNITS



The **GT Series** of Stanley Hydraulic Power Units are designed for continuous duty operation with an efficient oil cooler as standard equipment. With two different models to offer the underwater industry, Stanley Hydraulic Tools has a solid reputation of superior power units for top side work. The GT18 has a two position flow setting to provide 5 or 8 gpm and the GT23 can produce 8 or 12 gpm – all @ 2000 psi.



FEATURES

- Meets or exceeds HTMA hydraulic circuit design with superior cooling
- Electronically controlled engine speed – provides set flow
- Auto idle feature – lower fuel consumption and less noise
- Tool circuit lockout during engine startup – safety feature
- Quartz hour meter on control panel – records engine run time
- Lift & Latch handle with fold-up side handles
- 35-AH sealed, non-spillable, no maintenance battery located in covered compartment
- Electric start engine has pressure lubrication system, low engine oil shut down & spin on oil filter
- In tank hydraulic filter with dipstick and easy access filter replacement



SPECIFICATIONS

	GT18	GT23
Output Capacity	5 or 8 gpm / 20 or 30 lpm	8 or 12 gpm / 30 or 45 lpm
Pressure	2,000 psi / 140 bar	2,000 psi / 140 bar
Circuit Type	Open Center	Open Center
Hydraulic Reservoir Capacity	3 gallons / 11 liters	3 gallons / 11 liters
Couplers	HTMA Flush Face	HTMA Flush Face
Fuel Tank Capacity	7 gallons / 26½ liters	7 gallons / 26½ liters
Engine	Briggs & Stratton 18 HP Vanguard OHV, Gas	Briggs & Stratton 23 HP Vanguard OHV, Gas
Weight	330 lbs / 150 kg	340 lbs / 154 kg
Length	35" / 89 cm	35" / 89 cm
Width	21½" / 54.6 cm	21½" / 54.6 cm
Height	29" / 73.7 cm	29" / 73.7 cm
Heat Rejection	5 HP	5 HP

GT SERIES POWER UNITS

STANLEY®

ORDERING INFORMATION

PART NUMBER

GT18B01	Single Circuit 5 or 8 gpm, Briggs & Stratton 18 HP, CE
GT18B02	Single Circuit 5 or 8 gpm, Briggs & Stratton 18 HP
GT23B02	Single Circuit 8 or 12 gpm, Briggs & Stratton, 23 HP

ACCESSORIES

31848	Dual Hose, 50' x 1/2", with couplers
31972	Dual Hose, 25' x 1/2", with couplers
58633	Twinned Hose, 25' x 1/2", with couplers
58634	Twinned Hose, 50' x 1/2", with couplers
33212	Weather Cover
13360	Hose Basket Conversion Kit
64940	12 VDC Male Plug, Marine Type
64942	12 V Receptacle Assembly

When hydraulic hose exceeds 100' (30.4 m) in length, increase I.D. of both pressure and return hose. For more information, consult Stanley Hydraulic Tools.

IMPORTANT

To fill out a Product Warranty Recording form and for information on your warranty visit stanleyhydraulic.com and select the Warranty tab.



Note: The warranty recording form must be submitted to validate the warranty.

All Stanley Hydraulic Tools, parts, accessories and allied equipment are subject to design improvements, specifications and price changes at any time without notice and with no obligation to units already sold. Weights, dimensions and operating specifications listed herein are subject to change without notice. Where specifications are critical to your applications, please consult Stanley Hydraulic Tools.

GR29 UNDERWATER GRINDER

STANLEY



The Stanley Hydraulic **GR29** Grinder is a right angle grinder ("vertical grinder") that can be used for grinding and cleaning in underwater applications with a variety of wheels, brushes and attachments. The high torque gear motor drives a standard $\frac{5}{8}$ " - 11 threaded spindle. A 9" adjustable wheel guard, two position assist handle and trigger guard are standard. Painted hi-visibility yellow.

SPECIFICATIONS

Capacity	9" / 23 cm Wheel
Spindle	$\frac{5}{8}$ " - 11 Threaded
Circuit Type	Open Center
Flow Range	4-12 gpm / 15-45 lpm
Working Pressure	1000-2000 psi / 70-140 bar
Full Relief Setting	2250 psi / 155 bar
RPM	3200 @ 12 gpm / 45 lpm
Weight (with guard)	15 lbs / 6.8 kg
Length	11" / 28 cm
Width (with guard)	10 $\frac{1}{4}$ " / 26 cm
Hydraulic Ports	-8 SAE O-ring
Connection Size and Type	$\frac{3}{8}$ " Male Pipe Adapter
Couplers	Varies with model (See Ordering Information)
Hose Whips	No (See Accessories)

FEATURES

- Integral Stanley Hyrevz gear motor produces high torque
- Stainless Steel spools and fasteners
- Two position assist handle for right/left hand operation
- Oversized trigger with guard for diver comfort
- Adjustable wheel guard for infinite positions
- Plastisol covered handle for comfortable ergonomic grip
- Use with grinding wheels, hull scrubbing brushes, wire and nylon brushes, barnacle busters and Desmond wheels
- 3200 rpm @ 12 gpm
- Cast-in lifting eye

GR29 UNDERWATER GRINDER

STANLEY

ORDERING INFORMATION

PART NUMBER

GR29310 Grinder, Underwater, less couplers

GR2930101 Grinder, Underwater, couplers, CE

ACCESSORIES

03971 Flush-Face Coupling Set, $\frac{3}{8}$ " NPT

03974 Flush-Face Coupling Set, $\frac{1}{2}$ " NPT

06830 Hose Whip 18" long, -8 SAE x $\frac{1}{2}$ " NPT

02587 Grinding wheel for metal, 9" diameter x $\frac{5}{8}$ - 11 thd

02588 Grinding wheel for masonry, 9" diameter x $\frac{5}{8}$ - 11 thd

03691 Grinding wheel, 7" diameter x $\frac{5}{8}$ - 11 thread

05194 Adapter, $\frac{5}{8}$ - 11 thread, depressed center wheel

31848 Dual Hose, 50' x $\frac{1}{2}$ ", with couplers

31972 Dual Hose, 25' x $\frac{1}{2}$ ", with couplers

58633 Twinned Hose, 25' x $\frac{1}{2}$ ", with couplers

58634 Twinned Hose, 50' x $\frac{1}{2}$ ", with couplers

When hydraulic hose exceeds 100' (30.4 m) in length, increase I.D. of both pressure and return hose. For more information, consult Stanley Hydraulic Tools.

IMPORTANT

To fill out a Product Warranty Recording form and for information on your warranty visit stanleyhydraulic.com and select the Warranty tab.

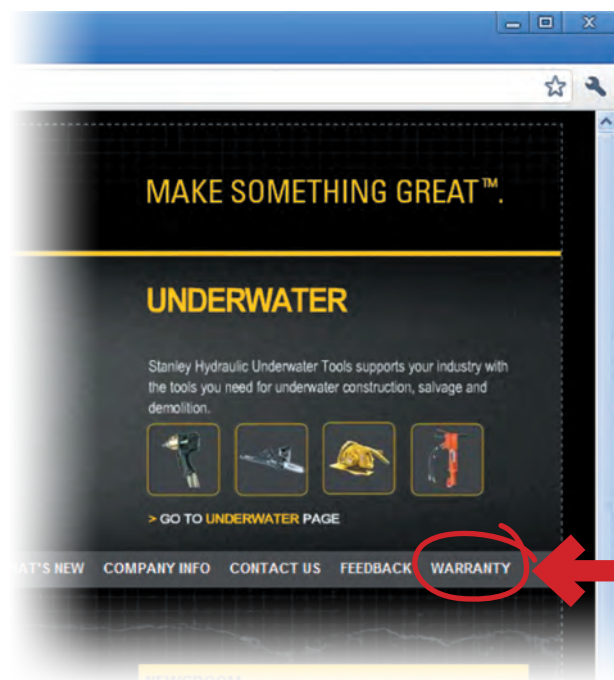

Note: The warranty recording form must be submitted to validate the warranty.

All Stanley Hydraulic Tools, parts, accessories and allied equipment are subject to design improvements, specifications and price changes at any time without notice and with no obligation to units already sold. Weights, dimensions and operating specifications listed herein are subject to change without notice. Where specifications are critical to your applications, please consult Stanley Hydraulic Tools.

DS11 UNDERWATER DIAMOND CHAIN SAW

STANLEY®

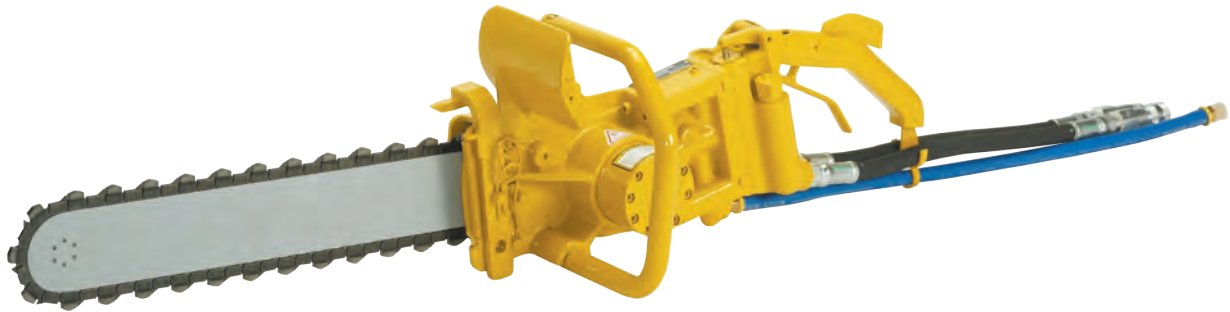

The **DS11** Diamond Chain Saw is specifically designed to cut solid concrete underwater. Cuts square corners without over-cut and can plunge cut sea walls up to 18" thick. Two available bar lengths (15" and 18") and two different chains depending on the amount of rebar and hardness of the concrete. A minimum of 20 PSI water pressure is required at the saw for cooling and lubrication of the bar and chain. Painted hi-visibility yellow.



FEATURES

- Direct drive motor - no chain coast when trigger is released
- Integral Stanley Hyrevz gear motor for durability and power
- Trigger activated water to bar and chain for lubrication
- Multi position trigger handle and Wall Walker reduces diver fatigue
- Heavy duty cast aluminum
- Cut steel reinforced concrete with Pinnacle chain
- Stainless Steel spool and fasteners
- Interlocking safety trigger and hand guard
- Pinnacle Chain: For Steel Reinforced, Heavy Aggregate Concrete
- Ultra Chain - For Light Wire Mesh, Soft/Green Concrete
- Order bar and chain separately – See Chart for Selection

SPECIFICATIONS

Capacity	15 or 18" / 38 or 45 cm Bar
Chain Type	Diamond Impregnated Chain Segments
Circuit Type	Open Center
Flow Range	12 gpm / 45 lpm
Working Pressure	1000-2000 psi / 70-140 bar
Full Relief Setting	2250 psi / 155 bar
Weight (less bar & chain)	28 lbs / 12.7 kg
Length (with bar & chain)	37 or 40" / 99 or 101.6 cm
Width	9" / 23 cm
Couplers	Yes
Hose Whips	Yes (½" NPT Male Thread)
Lubrication/Cooling	Internal Water Channels in Bar

DS11 UNDERWATER DIAMOND CHAIN SAW

STANLEY

The chart below will assist in chain selection for balance of cutting performance and chain life

Aggregate	Extra Hard		Hard		Medium		Soft		Abrasive
Material	Chert Flint	Basalt Quartz	Granite River Rock	Marble Limestone	Sandstone				Masonry, Brick, Block, Green Concrete
Approximate Moh's Scale	9	8	7	6	5	4	3		
Reinforcing Steel	Lots of Steel			Some Steel			No Steel		
	1"	Double Mat	Single Mat	#5	#4	#3	Wire Mesh		

Saw Chain Wear (in-ft)

Pinnacle-32 Pinnacle-39	150 in-ft	600-800 in-ft	2000 in-ft	
Ultra-32 Ultra-37		2000 in-ft		1500 in-ft

ORDERING INFORMATION

PART NUMBER

DS115000 Diamond Chain Saw, Underwater, No Bar & Chain
Order Bar and Chain Separately Below

ACCESSORIES

30305	15" Bar, Sprocket Nose
56801	15" Diamond Chain, Ultra 32
56803	15" Diamond Chain, Pinnacle, 32
30306	18" Bar, Sprocket Nose
56802	18" Diamond Chain, Ultra 37
58632	18" Diamond Chain, Pinnacle, 37
03971	Flush-Face Coupling Set, 3/8" NPT
03974	Flush-Face Coupling Set, 1/2" NPT
06830	Hose Whip 18" long, -8 SAE x 1/2" NPT
23517	Sprocket Wrench
31848	Dual Hose, 50' x 1/2", with couplers
31972	Dual Hose, 25' x 1/2", with couplers
58633	Twinned Hose, 25' x 1/2", with couplers
58634	Twinned Hose, 50' x 1/2", with couplers
20859	Diamond Chain Butterfly Repair Kit
20857	Chain Repair Spinner
20858	Chain Repair Breaker
DCP30101	Water Pump, 12 VDC, Battery Clip
DCP30100	Water Pump, 12 VDC, Marine Type Plug

When hydraulic hose exceeds 100' (30.4 m) in length, increase I.D. of both pressure and return hose. For more information, consult Stanley Hydraulic Tools.

All Stanley Hydraulic Tools, parts, accessories and allied equipment are subject to design improvements, specifications and price changes at any time without notice and with no obligation to units already sold. Weights, dimensions and operating specifications listed herein are subject to change without notice. Where specifications are critical to your applications, please consult Stanley Hydraulic Tools.

IMPORTANT

To fill out a Product Warranty Recording form and for information on your warranty visit stanleyhydraulic.com and select the Warranty tab.



Note: The warranty recording form must be submitted to validate the warranty.

DL07652 UNDERWATER DRILL

STANLEY



The Stanley **DL07** hydraulic drill is a forward/reverse, variable speed drill with a ½" keyed chuck for underwater drilling applications. The **DL07** has more than enough torque to drill most steel, masonry, wood or coral. A two position assist handle and trigger guard are standard. See chart below for speeds at select gpm of hydraulic flow. Painted hi-visibility yellow.

FEATURES

- Integral Stanley Hyrevz gear motor produces high torque
- Stainless Steel spools and fasteners
- Forward-Reverse with variable speed
- Dual position assist handle provides increased control
- Oversized trigger with guard for operator comfort
- Wiper seals on reversing and trigger spool
- Built in reverse check valve ensures long seal life
- Plastisol handle for comfortable ergonomic grip
- Forward position of handle provides better balance
- Open Center/Closed Center-Dual Spool Feature
- Cast-in lifting eye



SPECIFICATIONS

Chuck Capacity	½" / 12 mm
Performance	See Table at Right
Flow Range	3-10 gpm / 11.3-38 lpm
Working Pressure	1000-2000 psi / 70-140 bar
Full Relief Setting	2250 psi / 155 bar
Weight	7.8 lbs / 3.5 kg
Length	10½" / 26.7 cm
Hydraulic Ports	- 8 SAE O-ring
Couplers	No (See Accessories)
Hose Whips	Yes (¾" NPT Male Thread)

DL07 Speed/Hydraulic Flow

350 rpm @ 3 gpm / 11.3 lpm

475 rpm @ 4 gpm / 15 lpm

750 rpm @ 6 gpm / 23 lpm

1000 rpm @ 8 gpm / 30 lpm

1250 rpm @ 10 gpm / 38 lpm

DL07 Torque at PSI/Bar

4 ft lbs @ 500 psi 0.5 Nm @ 35 bar

9 ft lbs @ 1000 psi 1.2 Nm @ 70 bar

14 ft lbs @ 1500 psi 1.9 Nm @ 105 bar

19 ft lbs @ 2000 psi 2.6 Nm @ 140 bar

DL07652 UNDERWATER DRILL

STANLEY

ORDERING INFORMATION

PART NUMBER

DL07652 Drill, Underwater, 1/2" Capacity, Assist Handle, less couplers

ACCESSORIES

03971 Flush-Face Coupling Set, 3/8" NPT

03974 Flush-Face Coupling Set, 1/2" NPT

31848 Dual Hose, 50' x 1/2", with couplers

31972 Dual Hose, 25' x 1/2", with couplers

58633 Twinned Hose, 25' x 1/2", with couplers

58634 Twinned Hose, 50' x 1/2", with couplers

01857 Adjustable Chuck and Adapter, 3/4" square x 3/4"

04365 3/4" Chuck, 3 JT taper, use 7/16" bits

When hydraulic hose exceeds 100' (30.4 m) in length, increase I.D. of both pressure and return hose. For more information, consult Stanley Hydraulic Tools.

IMPORTANT

To fill out a Product Warranty Recording form and for information on your warranty visit stanleyhydraulic.com and select the Warranty tab.

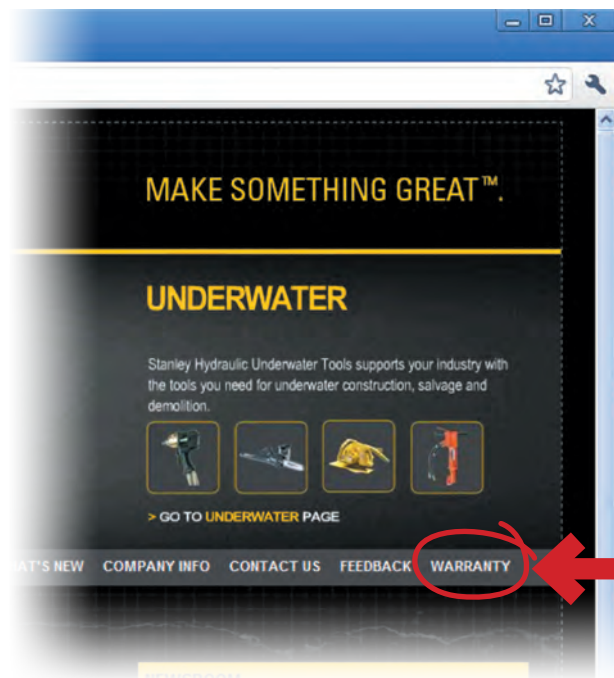

Note: The warranty recording form must be submitted to validate the warranty.

All Stanley Hydraulic Tools, parts, accessories and allied equipment are subject to design improvements, specifications and price changes at any time without notice and with no obligation to units already sold. Weights, dimensions and operating specifications listed herein are subject to change without notice. Where specifications are critical to your applications, please consult Stanley Hydraulic Tools.

CS11 UNDERWATER CHAIN SAW

STANLEY®



The **CS11** is an extreme duty hydraulic powered chain saw for cutting all types of wood structures underwater - including bridge pilings, pier and dock timbers. It's robust design and high torque gear motor provides divers instant chain speed to cut through the toughest timbers with ease. The power to weight ratio is significantly higher than any other wood cutting chain saw and is available with bar lengths up to 42" (107 cm). Painted hi-visibility yellow.



FEATURES

- Integral Stanley Hyrevz gear motor produces high torque
- Direct drive motor – no chain coast when trigger is released
- Stainless steel spool and fasteners
- Interlocking safety trigger and hand guard
- Large assist handle
- Manual chain oiler
- Adjustable automatic chain oiler
- Bucking cleat
- Wide flow range
- Order bar and chain separately

SPECIFICATIONS

Cut Capacity	24, 32, 36 & 42" / 61, 81, 91 & 107 cm (See Ordering Information)
Chain Type	3/8" Pitch
Circuit Type	Open Center
Flow Range	10-14 gpm / 38-53 lpm
Optimum Flow	14 gpm / 53 lpm
Working Pressure	1500-2000 psi / 105-140 bar
Full Relief Setting	2250 psi / 155 bar
Motor Speed @ 12 gpm	5295 rpm
Chain Speed @ 12 gpm	2591' per min / 13,16 meters per sec
Weight (less bar/chain)	17 lbs / 7.7 kg
Length (less bar/chain)	17" / 43 cm
Width	9" / 23 cm
Hydraulic Ports	-8 SAE O-ring
Couplers	Yes
Hose Whips	Yes

CS11 UNDERWATER CHAIN SAW

STANLEY®

ORDERING INFORMATION

PART NUMBER

CS113N0001 Chain Saw, Underwater, Couplers, CE, No Bar & Chain Order Bar and Chain Separately Below

ACCESSORIES

03974	Flush-Face Coupling Set, ½" NPT
06830	Hose Whip 18" long, -8 SAE x ½" NPT
72947*	24"/61 cm Sprocket Nose Saw Bar
72951*	24"/61 cm Saw Chain
72948*	32"/76 cm Sprocket Nose Saw Bar
72952*	32"/76 cm Saw Chain
72949*	36"/91 cm Sprocket Nose Saw Bar
72953*	36"/91 cm Saw Chain
72950*	42"/91 cm Sprocket Nose Saw Bar
72954*	42"/91 cm Saw Chain
31848	Dual Hose, 50' x ½", with couplers
31972	Dual Hose, 25' x ½", with couplers
58633	Twinned Hose, 25' x ½", with couplers
58634	Twinned Hose, 50' x ½", with couplers
72960	Stud Kit

When hydraulic hose exceeds 100' (30.4 m) in length, increase I.D. of both pressure and return hose. For more information, consult Stanley Hydraulic Tools.

IMPORTANT

To fill out a Product Warranty Recording form and for information on your warranty visit stanleyhydraulic.com and select the Warranty tab.



Note: The warranty recording form must be submitted to validate the warranty.

*Indicates new bars and chains with different stud size. If you are purchasing a new bar on an old saw it will require a new stud kit (part 72960). S/N 053112001 and up.

All Stanley Hydraulic Tools, parts, accessories and allied equipment are subject to design improvements, specifications and price changes at any time without notice and with no obligation to units already sold. Weights, dimensions and operating specifications listed herein are subject to change without notice. Where specifications are critical to your applications, please consult Stanley Hydraulic Tools.

CS06 UNDERWATER CHAIN SAW

STANLEY



The **CS06** is a hydraulic powered chain saw for cutting all types of wood structures underwater - including bridge pilings, pier and dock timbers. It's compact design and high torque gear motor provides divers instant chain speed to cut through the toughest timbers with ease. The power to weight ratio is significantly higher than any other wood cutting chain saw and is available with bar lengths up to 20" (51 cm). Painted hi-visibility yellow.



FEATURES

- Integral Stanley Hyrevz gear motor produces high torque
- Direct drive motor - no chain coast when trigger is released
- Stainless Steel spool and fasteners
- Interlocking safety trigger and hand guard
- Low kick back bar and chain - standard
- Open Center/Closed Center-Dual Spool Feature
- Large assist handle
- Adjustable chain oiler
- Bucking cleat
- Wide flow range

SPECIFICATIONS

Cut Capacity	15 & 20" / 38 & 51 cm (See Ordering Information)
Chain Drive	Standard Floating Rim Sprocket & Wear Plates
Chain Type	0.325" Pitch
Flow Range	7-9 gpm / 26-34 lpm
Optimum Flow	8 gpm / 30 lpm
Working Pressure	1500-2000 psi / 105-140 bar
Full Relief Setting	2250 psi / 155 bar
Motor Speed @ 8 gpm	8540 rpm
Chain Speed @ 8 gpm	3238' per min / 16,45 meters per sec
Weight (less bar/chain)	7.3 lbs / 3.3 kg
Length (less bar/chain)	14" / 36 cm
Width	9" / 23 cm
Hydraulic Ports	-8 SAE O-ring
Connection Size and Type	3/8" Male Pipe Adapter
Couplers	No (See accessories)
Hose Whips	No (See accessories)



CS06 UNDERWATER CHAIN SAW

STANLEY

ORDERING INFORMATION

PART NUMBER

CS06920 Chain Saw, Underwater, 15" Cut Capacity, with Bar & Chain

CS06930 Chain Saw, Underwater, 20" Cut Capacity, with Bar & Chain

ACCESSORIES

03971 Flush-Face Coupling Set, 3/8" NPT

03974 Flush-Face Coupling Set, 1/2" NPT

06830 Hose Whip 18" long, -8 SAE x 1/2" NPT

07638 15" Saw Bar

07641 15" Saw Chain

07639 20" Saw Bar

07642 20" Saw Chain

11464 Srench
(combination screwdriver-bar nut wrench)

31848 Dual Hose, 50' x 1/2", with couplers

31972 Dual Hose, 25' x 1/2", with couplers

58633 Twinned Hose, 25' x 1/2", with couplers

58634 Twinned Hose, 50' x 1/2", with couplers

When hydraulic hose exceeds 100' (30.4 m) in length, increase I.D. of both pressure and return hose. For more information, consult Stanley Hydraulic Tools.

IMPORTANT

To fill out a Product Warranty Recording form and for information on your warranty visit stanleyhydraulic.com and select the Warranty tab.

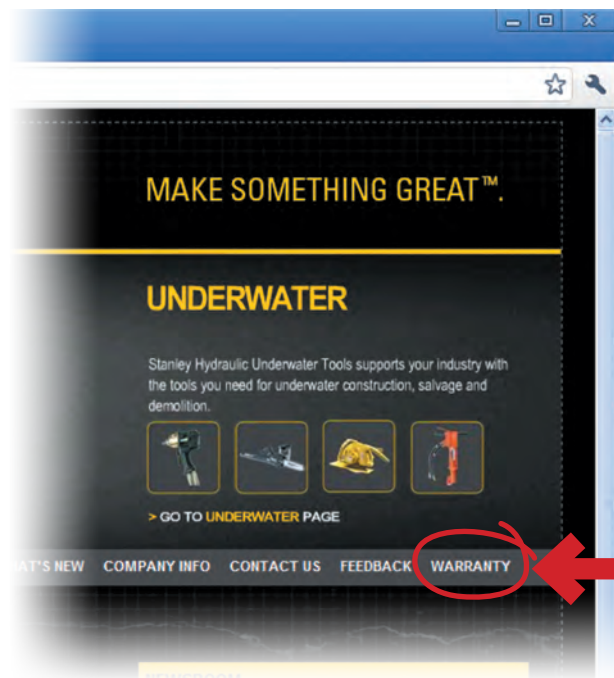

Note: The warranty recording form must be submitted to validate the warranty.

All Stanley Hydraulic Tools, parts, accessories and allied equipment are subject to design improvements, specifications and price changes at any time without notice and with no obligation to units already sold. Weights, dimensions and operating specifications listed herein are subject to change without notice. Where specifications are critical to your applications, please consult Stanley Hydraulic Tools.

C023 UNDERWATER CUT-OFF SAW

STANLEY[®]



The **C023** Cut-Off Saw is a hydraulic powered saw for dimensional cutting of metal, concrete, rock, masonry and coral. It has a high torque gear motor and 10" blade capacity for abrasive and diamond wheels with a 1" arbor. The **C023** is designed for underwater operation and is painted hi-visibility yellow.

FEATURES

- Integral Stanley Hyrevz gear motor produces high torque
- Direct drive motor
- Stainless Steel spool and fasteners
- Adjustable shoe for precise cuts
- Interlocking safety trigger
- Cast aluminum handle and guard for durability
- Counter-clockwise rotation
- Wide flow range

SPECIFICATIONS

Capacity	10" / 25.4 cm wheel
Performance	3275 rpm @ 15 gpm
Arbor	1" / 2½ cm
Circuit Type	Open Center
Flow Range	10-15 gpm / 38-57 lpm
Optimum Flow	15 gpm / 57 lpm
Working Pressure	1500-2000 psi / 105-140 bar
Full Relief Setting	2250 psi / 155 bar
Weight	23 lbs / 10.4 kg
Length	19½" / 49½ cm
Width	11" / 28 cm
Hydraulic Ports	-8 SAE O-ring
Connection Size and Type	½" Male Pipe Hose End
Couplers	No (See Accessories)
Hose Whips	Yes



C023 UNDERWATER CUT-OFF SAW

STANLEY

ORDERING INFORMATION

PART NUMBER

C023341 Cut-Off Saw, Underwater, 10" capacity with 1" arbor, less couplers

ACCESSORIES

03971	Flush-Face Coupling Set, 3/8" NPT
03974	Flush-Face Coupling Set, 1/2" NPT
06830	Hose Whip 18" long, -8 SAE x 1/2" NPT
03694	10" / 25.4 cm diameter, 1" arbor, diamond blade for concrete
04116	10" / 25.4 cm diameter, 1" arbor, abrasive blade for concrete
04117	10" / 25.4 cm diameter, 1" arbor, abrasive blade for aluminum and metal
31848	Dual Hose, 50' x 1/2", with couplers
31972	Dual Hose, 25' x 1/2", with couplers
58633	Twinned Hose, 25' x 1/2", with couplers
58634	Twinned Hose, 50' x 1/2", with couplers

When hydraulic hose exceeds 100' (30.4 m) in length, increase I.D. of both pressure and return hose. For more information, consult Stanley Hydraulic Tools.

IMPORTANT

To fill out a Product Warranty Recording form and for information on your warranty visit stanleyhydraulic.com and select the Warranty tab.

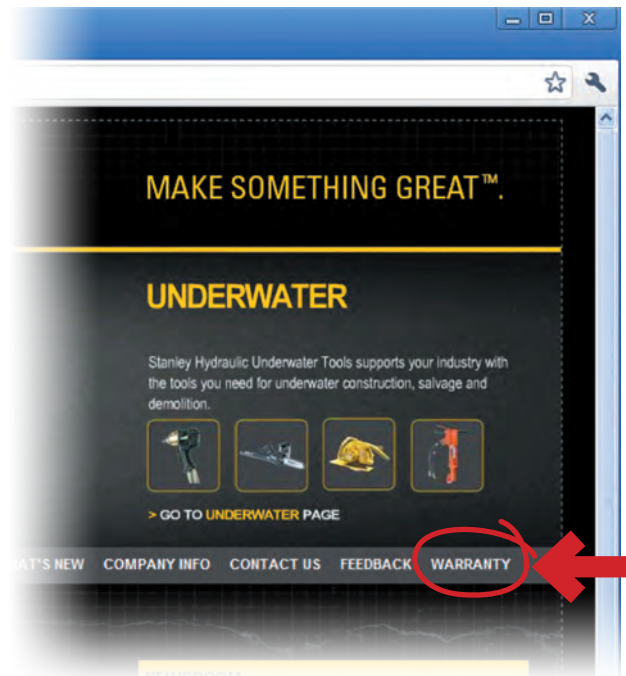

Note: The warranty recording form must be submitted to validate the warranty.

All Stanley Hydraulic Tools, parts, accessories and allied equipment are subject to design improvements, specifications and price changes at any time without notice and with no obligation to units already sold. Weights, dimensions and operating specifications listed herein are subject to change without notice. Where specifications are critical to your applications, please consult Stanley Hydraulic Tools.

CH18 UNDERWATER CHIPPING HAMMER

STANLEY®



The Stanley **CH18311** Chipper is a compact, hydraulic powered, underwater chipping hammer used for medium chipping of concrete, masonry and rock.



The ergonomic "D" handle with inside trigger prevents accidental operation of the tool. The handle is Plastisol coated for diver comfort. The **CH18** has a slide latch design tool bit retainer that will accept .580 hex shank, round collar tool bits. Painted hi-visibility yellow.

SPECIFICATIONS

Steel Capacity	.580 Hex Shank, Round Collar Tool Bits
Handle Type	"D" Handle, with Inside Trigger
Circuit Type	Open Center
Flow Range	7-9 gpm / 26-34 lpm
Optimum Flow	8 gpm / 30 lpm
Working Pressure	1500-2000 psi / 105-140 bar
Full Relief Setting	2250 psi / 155 bar
Weight (less tool bit)	18.2 lbs / 8.2 kg
Length	20" / 51 cm
Hydraulic Ports	-6 SAE O-ring
Couplers	No (See Accessories)
Hose Whips	Yes ($\frac{3}{8}$ " NPT Male thread)

FEATURES

- Ergonomic "D" handle with inside trigger
- Stainless Steel spool and fasteners
- Handle is Plastisol coated for diver comfort
- Uses standard .580 hex shank, round collar tool bits
- High power to weight ratio
- Operates in any position

CH18 UNDERWATER CHIPPING HAMMER

STANLEY

ORDERING INFORMATION

PART NUMBER

CH18311 Chipping Hammer, Underwater, .580 Hex Shank, Round Collar, Slide Retainer, less couplers

ACCESSORIES

03971	Flush-Face Coupling Set, 3/8" NPT
03974	Flush-Face Coupling Set, 1/2" NPT
31848	Dual Hose, 50' x 1/2", with couplers
31972	Dual Hose, 25' x 1/2", with couplers
58633	Twinned Hose, 25' x 1/2", with couplers
58634	Twinned Hose, 50' x 1/2", with couplers
02278	Flat Chisel, 1" x 18", .580 Hex Shank, Round Collar
02279	Bull Point, 1" x 18", .580 Hex Shank, Round Collar
03690	Chisel Bit, 1" x 9", .580 Hex Shank, Round Collar
03963	Chisel Bit, 2" x 5", .580 Hex Shank, Round Collar

When hydraulic hose exceeds 100' (30.4 m) in length, increase I.D. of both pressure and return hose. For more information, consult Stanley Hydraulic Tools.

IMPORTANT

To fill out a Product Warranty Recording form and for information on your warranty visit stanleyhydraulic.com and select the Warranty tab.

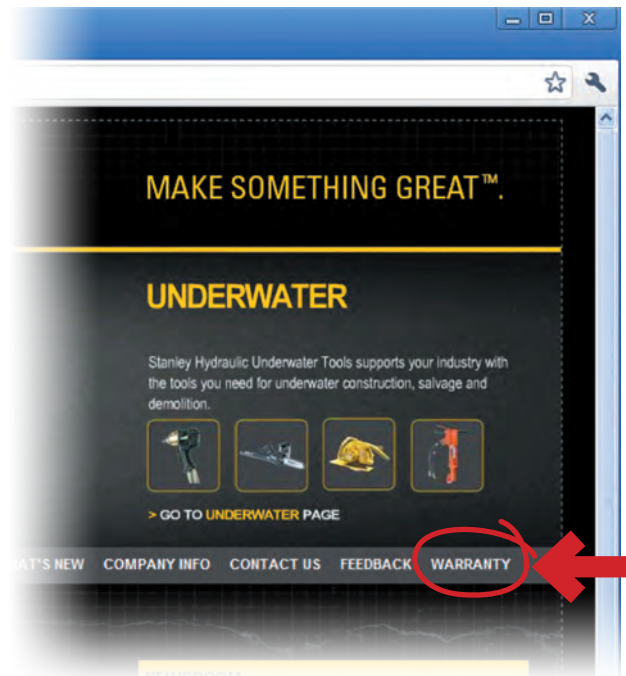

Note: The warranty recording form must be submitted to validate the warranty.

All Stanley Hydraulic Tools, parts, accessories and allied equipment are subject to design improvements, specifications and price changes at any time without notice and with no obligation to units already sold. Weights, dimensions and operating specifications listed herein are subject to change without notice. Where specifications are critical to your applications, please consult Stanley Hydraulic Tools.

CH15 UNDERWATER CHIPPING HAMMER

STANLEY®



The **CH15** is a small and compact hydraulic Chipping Hammer used for light chipping and scaling underwater.



The ergonomic "D" handle and short 17" over all length, makes it easy to use in confined and hard to access locations. The floating trigger design requires minimal pressure across any part of its surface to engage the tool. The trigger is protected within the handle to prevent accidental operation of the tool. The **CH15** has a solid bit retainer and will accept .580 hex shank, oval collar tool bits. Painted hi-visibility yellow.

SPECIFICATIONS

Steel Capacity	.580 Hex Shank, Oval Collar Tool Bits
Handle Type	"D" Handle, with Inside Trigger
Circuit Type	Open Center
Flow Range	7-9 gpm / 26-34 lpm
Optimum Flow	8 gpm / 30 lpm
Working Pressure	1000-2000 psi / 70-140 bar
Full Relief Setting	2250 psi / 155 bar
Weight (less tool bit)	16 lbs / 7.25 kg
Length	17" / 43 cm
Hydraulic Ports	-6 SAE O-ring
Couplers	Yes
Hose Whips	Yes ($\frac{3}{8}$ " NPT Male thread)

FEATURES

- Ergonomic "D" handle with inside trigger
- Stainless Steel spool and fasteners
- Tool body has rubber coating for diver comfort
- Floating trigger design requires minimal pressure
- Uses standard .580 hex shank, oval collar tool bits
- High power to weight ratio
- Operates in any position
- CE Certified

CH15 UNDERWATER CHIPPING HAMMER

STANLEY

ORDERING INFORMATION

PART NUMBER

CH1533101 Chipping Hammer, Underwater, CE, .580 Hex Shank, Oval Collar, Solid Retainer, with couplers

ACCESSORIES

03971	Flush-Face Coupling Set, 3/8" NPT
03974	Flush-Face Coupling Set, 1/2" NPT
31848	Dual Hose, 50' x 1/2", with couplers
31972	Dual Hose, 25' x 1/2", with couplers
58633	Twinned Hose, 25' x 1/2", with couplers
58634	Twinned Hose, 50' x 1/2", with couplers
66256	Moil Point, 9", .580 Hex Shank, Oval Collar
66257	Narrow Chisel, 9", .580 Hex Shank, Oval Collar

When hydraulic hose exceeds 100' (30.4 m) in length, increase I.D. of both pressure and return hose. For more information, consult Stanley Hydraulic Tools.

IMPORTANT

To fill out a Product Warranty Recording form and for information on your warranty visit stanleyhydraulic.com and select the Warranty tab.



Note: The warranty recording form must be submitted to validate the warranty.

All Stanley Hydraulic Tools, parts, accessories and allied equipment are subject to design improvements, specifications and price changes at any time without notice and with no obligation to units already sold. Weights, dimensions and operating specifications listed herein are subject to change without notice. Where specifications are critical to your applications, please consult Stanley Hydraulic Tools.

BR87 UNDERWATER BREAKER/DRIVER

STANLEY®



SPECIFICATIONS

Performance	1080 bpm @ 8 gpm
Steel Capacity	1½" x 6" Hex
Handle Type	T-Handle
Circuit Type	Open Center
Flow Range	7-9 gpm / 26-34 lpm
Optimum Flow	8 gpm / 30 lpm
Working Pressure	1500-2000 psi / 105-140 bar
Full Relief Setting	2250 psi / 155 bar
Weight (less tool bit)	85 lbs / 39 kg
Length	29" / 73.6 cm
Width (at handles)	16" / 41 cm
Hydraulic Ports	-8 SAE O-ring
Couplers	No (See Accessories)
Hose Whips	Yes (¾" NPT Male thread)

FEATURES

- T-Handle with large on/off trigger for precise control
- Stainless Steel spool and fasteners
- Trouble free diaphragm accumulator provides additional blow energy and reduces recoil
- Feathering on/off valve allows easy initial tool bit placement
- Uses standard 1½" x 6" hex shank tool bits
- Four tie rod design for durability
- Operates in any position
- Modular design for ease of service
- Latch retainer



The **BR87** is the largest breaker in Stanley Hydraulic Tools line up of underwater paving breakers. The **BR87** is in the 90 lb class of breakers and with it's long piston stroke, is our hardest hitting hand held breaker. It is used for heavy concrete and rock breaking, coral removal and rod and anchor driving. The feathering on/off valve controls speed and allows easier initial tool placement. Standard 1½" x 6" hex chuck and latch retainer. Painted hi-visibility yellow.

BR87 UNDERWATER BREAKER/DRIVER

STANLEY

ORDERING INFORMATION

PART NUMBER

BR87320 Paving Breaker, Underwater, 1 1/8" Hex, less couplers

ACCESSORIES

03971	Flush-Face Coupling Set, 3/8" NPT
03974	Flush-Face Coupling Set, 1/2" NPT
31848	Dual Hose, 50' x 1/2", with couplers
31972	Dual Hose, 25' x 1/2", with couplers
58633	Twinned Hose, 25' x 1/2", with couplers
58634	Twinned Hose, 50' x 1/2", with couplers
02331	Clay Spade, 1 1/8" Hex, 5 1/2" Wide Blade
02332	Asphalt Cutter, 1 1/8" Hex, 5" Wide Blade
02333	Moil Point, 1 1/8" Hex, 14" under collar
02334	3" Wide Chisel, 1 1/8" Hex, 14" under collar
03990	Narrow Chisel, 1 1/8" Hex, 14" under collar
04176	Rod Driver, 1 1/8" Hex, 1" rod
08106	Asphalt Wedge, 1 1/8" Hex

When hydraulic hose exceeds 100' (30.4 m) in length, increase I.D. of both pressure and return hose. For more information, consult Stanley Hydraulic Tools.

IMPORTANT

To fill out a Product Warranty Recording form and for information on your warranty visit stanleyhydraulic.com and select the Warranty tab.

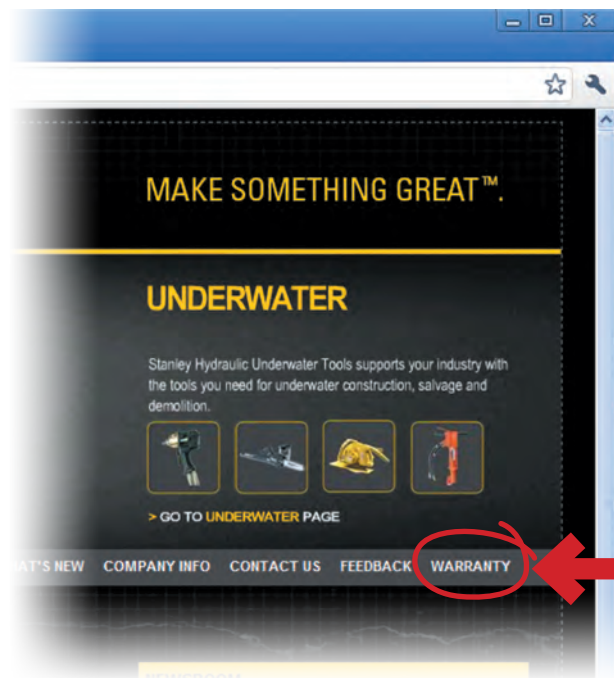

Note: The warranty recording form must be submitted to validate the warranty.

All Stanley Hydraulic Tools, parts, accessories and allied equipment are subject to design improvements, specifications and price changes at any time without notice and with no obligation to units already sold. Weights, dimensions and operating specifications listed herein are subject to change without notice. Where specifications are critical to your applications, please consult Stanley Hydraulic Tools.

BR67 UNDERWATER BREAKER/DRIVER

STANLEY®



SPECIFICATIONS

Performance	1300 bpm @ 8 gpm
Steel Capacity	1½" x 6" Hex
Handle Type	T-Handle
Circuit Type	Open Center
Flow Range	7-9 gpm / 26-34 lpm
Optimum Flow	8 gpm / 30 lpm
Working Pressure	1500-2000 psi / 105-140 bar
Full Relief Setting	2250 psi / 155 bar
Weight (less tool bit)	73 lbs / 33 kg
Length	29" / 73.6 cm
Width (at handles)	16" / 41 cm
Hydraulic Ports	-8 SAE O-ring
Couplers	No (See Accessories)
Hose Whips	Yes (¾" NPT Male thread)

FEATURES

- T-Handle with large on/off trigger for precise control
- Stainless Steel spool and fasteners
- Trouble free diaphragm accumulator provides additional blow energy and reduces recoil
- Feathering on/off valve allows easy initial tool bit placement
- Uses standard 1½" x 6" hex shank tool bits
- Four tie rod design for durability
- Operates in any position
- Modular design for ease of service
- Latch retainer



The **BR67** is a medium sized breaker in Stanley Hydraulic Tools line up of underwater paving breakers. The **BR67** is in the 70 lbs class of breakers and is used for medium concrete and rock breaking, coral removal and rod driving. The feathering on/off valve controls speed and allows easier initial tool placement. Standard 1½" x 6" hex chuck and latch retainer. Painted hi-visibility yellow.

BR67 UNDERWATER BREAKER/DRIVER

STANLEY[®]

ORDERING INFORMATION

PART NUMBER

BR67320 Paving Breaker, Underwater, 1½" Hex, less couplers

ACCESSORIES

03971	Flush-Face Coupling Set, ¾" NPT
03974	Flush-Face Coupling Set, ½" NPT
31848	Dual Hose, 50' x ½", with couplers
31972	Dual Hose, 25' x ½", with couplers
58633	Twinned Hose, 25' x ½", with couplers
58634	Twinned Hose, 50' x ½", with couplers
02331	Clay Spade, 1½" Hex, 5½" Wide Blade
02332	Asphalt Cutter, 1½" Hex, 5" Wide Blade
02333	Moil Point, 1½" Hex, 14" under collar
02334	3" Wide Chisel, 1½" Hex, 14" under collar
03990	Narrow Chisel, 1½" Hex, 14" under collar
04176	Rod Driver, 1½" Hex, 1" rod
08106	Asphalt Wedge, 1½" Hex

When hydraulic hose exceeds 100' (30.4 m) in length, increase I.D. of both pressure and return hose. For more information, consult Stanley Hydraulic Tools.

IMPORTANT

To fill out a Product Warranty Recording form and for information on your warranty visit stanleyhydraulic.com and select the Warranty tab.

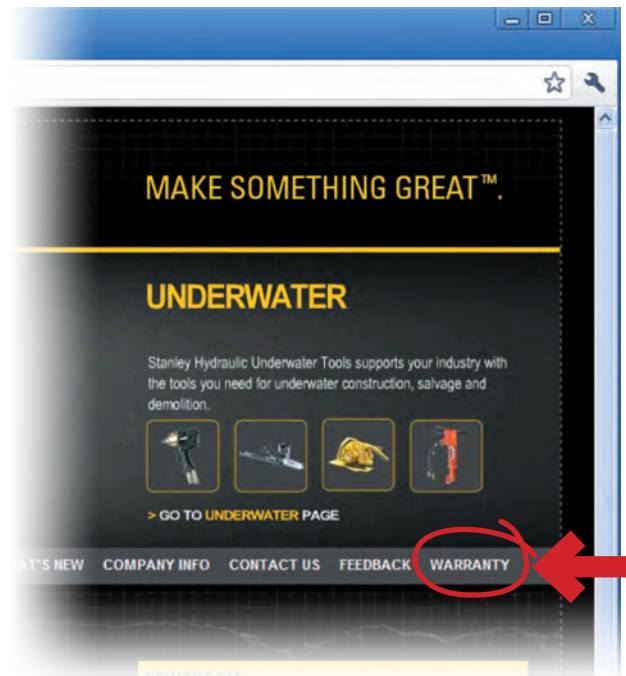

Note: The warranty recording form must be submitted to validate the warranty.

All Stanley Hydraulic Tools, parts, accessories and allied equipment are subject to design improvements, specifications and price changes at any time without notice and with no obligation to units already sold. Weights, dimensions and operating specifications listed herein are subject to change without notice. Where specifications are critical to your applications, please consult Stanley Hydraulic Tools.

BR45 UNDERWATER BREAKER/DRIVER

STANLEY®



SPECIFICATIONS

Performance	1525 bpm @ 8 gpm
Steel Capacity	1" x 4 1/4" Hex
Handle Type	T-Handle
Circuit Type	Open Center
Flow Range	7-9 gpm / 26-34 lpm
Optimum Flow	8 gpm / 30 lpm
Working Pressure	1500-2000 psi / 105-140 bar
Full Relief Setting	2250 psi / 155 bar
Weight (less tool bit)	43 lbs / 19.5 kg
Length	25" / 63.4 cm
Width (at handles)	14" / 35 cm
Hydraulic Ports	-8 SAE O-ring
Couplers	No (See Accessories)
Hose Whips	Yes (3/8" NPT Male thread)

The **BR45** is a rugged, powerful and lightweight breaker in the 40-55 lb class used for light to medium concrete, rock and coral breaking and removal.



The **BR45** is the smallest breaker in the Stanley Hydraulic Tool lineup of underwater breakers. The feathering on/off valve controls speed and allows easier initial tool placement. Standard 1" hex chuck and latch retainer. Painted hi-visibility yellow.

FEATURES

- T-Handle with large on/off trigger for precise control
- Stainless Steel spool and fasteners
- Trouble free diaphragm accumulator provides additional blow energy and reduces recoil
- Feathering on/off valve allows easy initial tool bit placement
- Uses standard 1" x 4 1/4" hex shank tool bits
- Four tie rod design for durability
- Operates in any position
- Modular design for ease of service
- Latch retainer

BR45 UNDERWATER BREAKER/DRIVER

STANLEY

ORDERING INFORMATION

PART NUMBER

BR45350 Paving Breaker, Underwater, 1" Hex, less couplers

ACCESSORIES

03971	Flush-Face Coupling Set, 3/8" NPT
03974	Flush-Face Coupling Set, 1/2" NPT
31848	Dual Hose, 50' x 1/2", with couplers
31972	Dual Hose, 25' x 1/2", with couplers
58633	Twinned Hose, 25' x 1/2", with couplers
58634	Twinned Hose, 50' x 1/2", with couplers
07702	Moil Point, 1" Hex, 14" under collar
07703	Narrow Chisel, 1" Hex, 14" under collar
07704	3" Wide Chisel, 1" Hex, 14" under collar
07705	Clay Spade, 1" Hex, 5 1/2" Wide Blade
07706	Asphalt Wedge, 1" Hex, 3" Wide Blade

When hydraulic hose exceeds 100' (30.4 m) in length, increase I.D. of both pressure and return hose. For more information, consult Stanley Hydraulic Tools.

IMPORTANT

To fill out a Product Warranty Recording form and for information on your warranty visit stanleyhydraulic.com and select the Warranty tab.

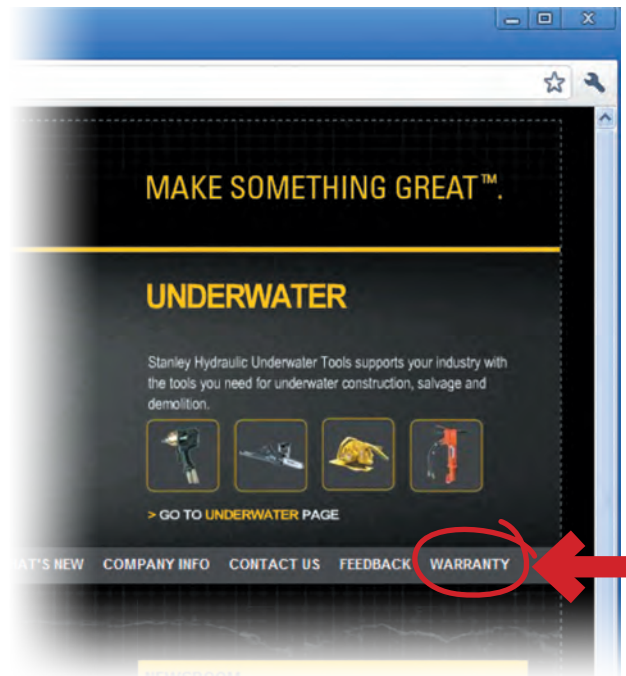

Note: The warranty recording form must be submitted to validate the warranty.

All Stanley Hydraulic Tools, parts, accessories and allied equipment are subject to design improvements, specifications and price changes at any time without notice and with no obligation to units already sold. Weights, dimensions and operating specifications listed herein are subject to change without notice. Where specifications are critical to your applications, please consult Stanley Hydraulic Tools.